

SITE PLAN OF PLOT FOR BANK, ART GALLERY, HOTEL & FILLING STATION AT ARPOORI PURAM SCHEME.

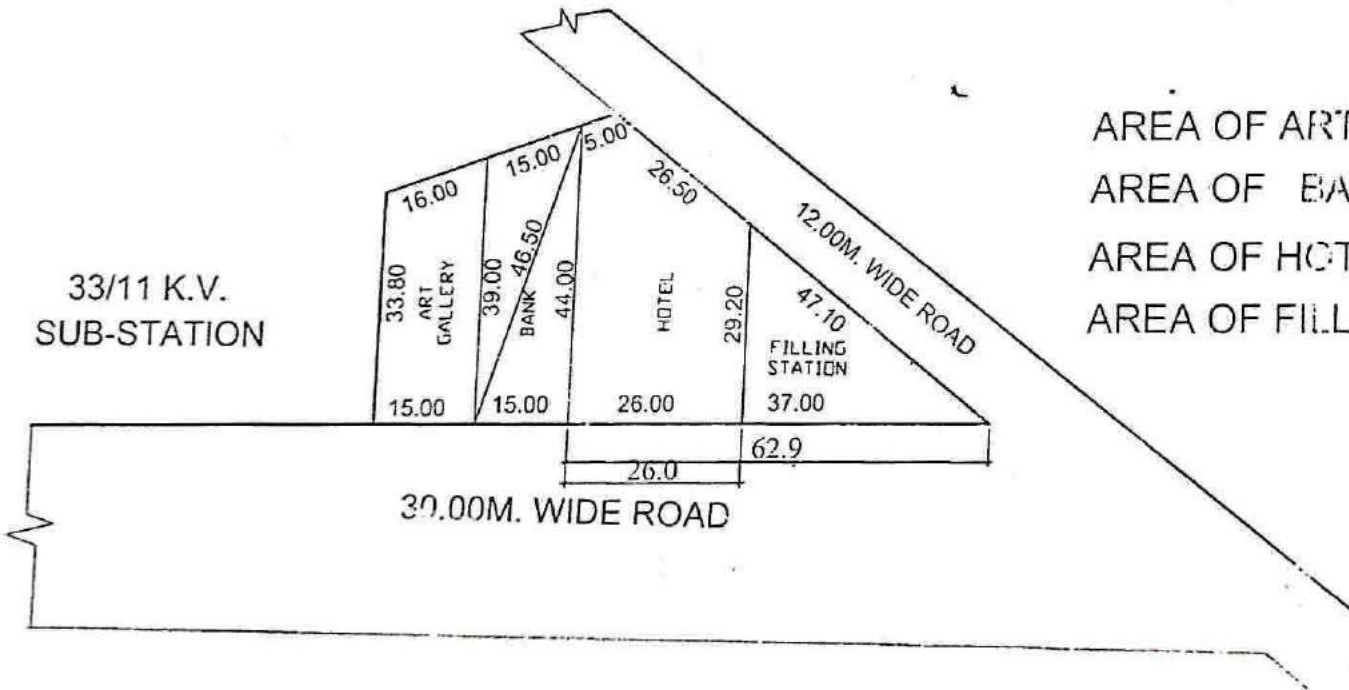
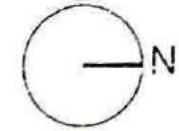

- AREA OF ART GALLERY = 540 SQM
- AREA OF BANK = 580.00 SQM
- AREA OF HOTEL = 1007.00 SQM
- AREA OF FILLING STATION = 538.00 SQM

DRAWN BY: *[Signature]* AMIN
 MEASURED BY: *[Signature]* 12/9/14 A.E.
 E.E. *[Signature]* T.E.H.(L.A.)
 T.P. *[Signature]* C.A.T.P.
 SECY. *[Signature]*

PLAN OF COMMERCIAL PLOT NO- BH/C-2 (BHAURAO DEVRAS AVASIYANA) AT PRATAP VIHAR SECTOR 12 G.M.P

TOTAL PLOT AREA=1520.04 SQM.

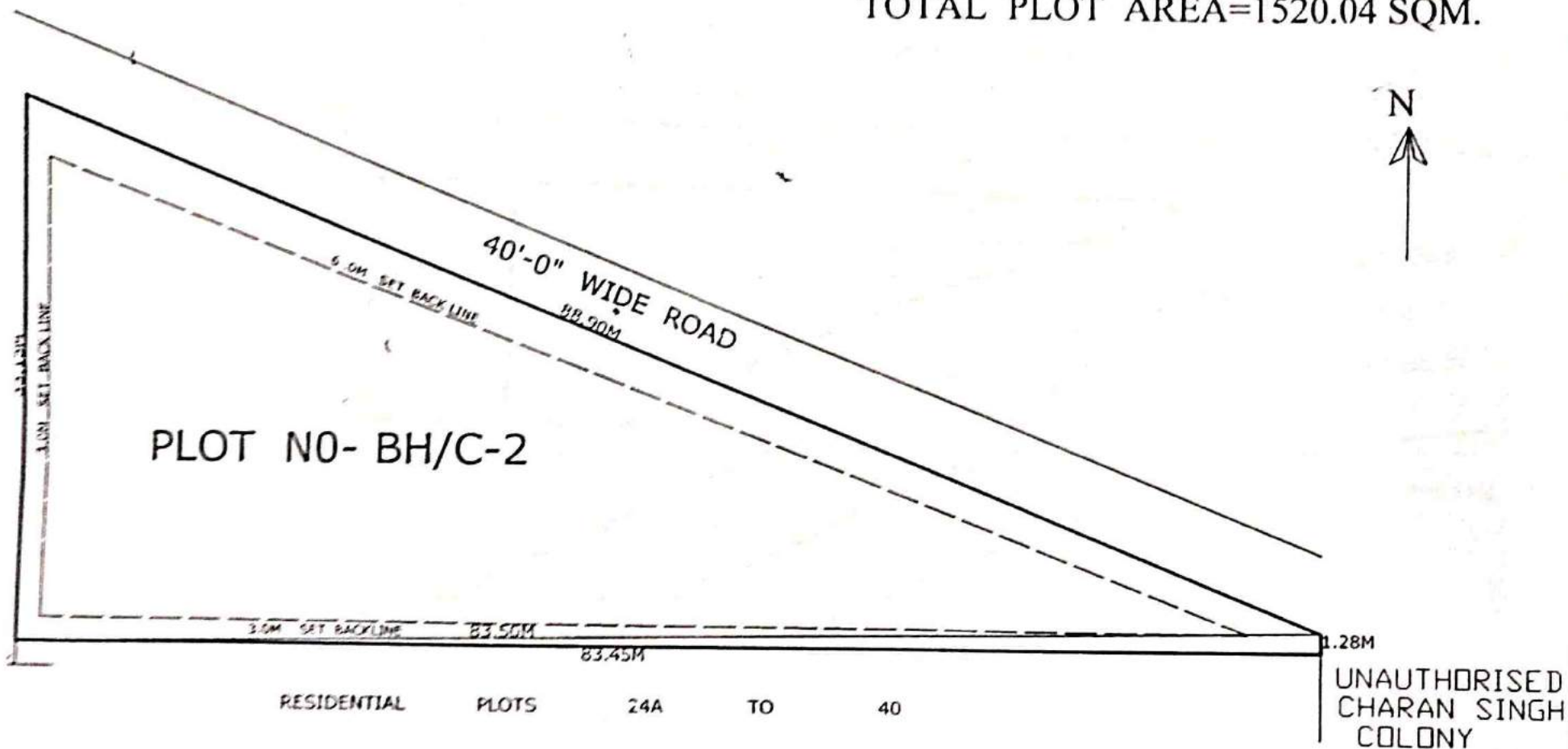

[Signature]
26/12/12
PREPARED BY.

[Signature]
27/12/12
COMPARED BY.

[Signature]
27/12/12
S.E.
(Savitri Kumari)
MEASURED BY.

[Signature]
27/12/12
(Neeraj Kumar Gulota)
ASSTT.ENG.

[Signature]
27/12/12
TOWN PLANNER

SITE PLAN OF POLICE CHOWKI PLOT, COMMUNITY CENTER PLOT & HIGH SCHOOL PLOT A POCKET-B MADHUBAN BAPUDHAM YOJNA , GDA, GZB.

HIGH SCHOOL PLOT - B/H.S.-1 = 1567.68 SQ.M.

COMM. CENTER PLOT - B/C.C.-1 = 2832.56 SQ.M.

POLICE CHOWKI PLOT - B/P.C.-1 = 3098.30 SQ.M.

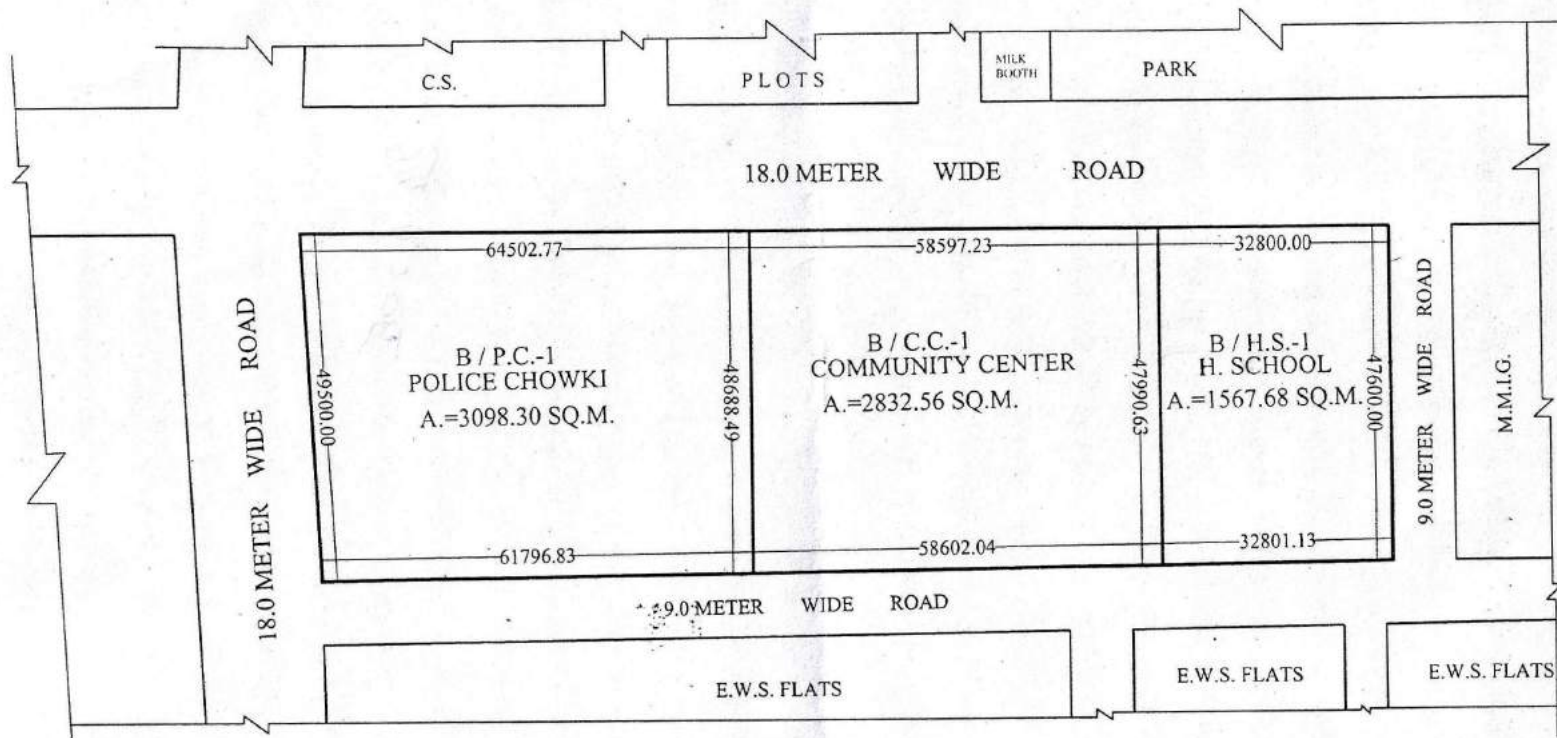

Shrawi
11-02-21
PREPARED BY.

Sanved
25/02/21
COMPARED BY.

[Signature]
MEAS.&AREA CAL.(J.E.)

[Signature]
A.E.

[Signature]
E.E.

[Signature]
TOWN PLANNER

REV. SITE PLAN OF MULTIPURPOSE COMMUNITY FACILITIES NEAR D.P.S., SK-IV, INDIRAPURAM

TOTAL AREA OF THE LAND - 20268.80 SQ.M

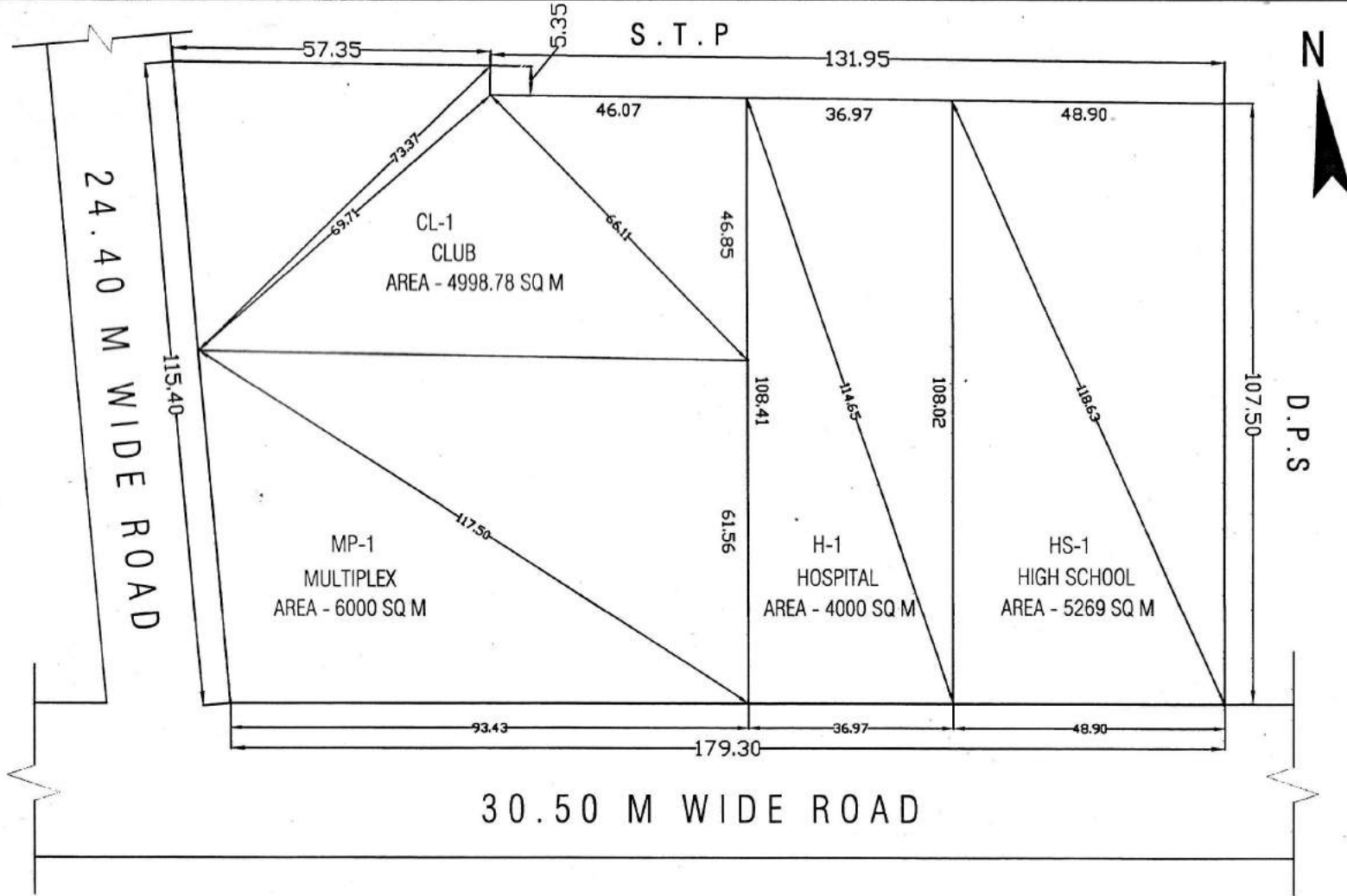

[Signature]
D/MAN
01/3/17

[Signature]
J.E.

[Signature]
A.E.

[Signature]
E.E.
21/3/17

[Signature]
T.P.
03/3/17

[Signature]
C.A.T.P.

[Signature]
SECRETARY

[Signature]
VICE CHAIRMAN

PART LAYOUT PLAN OF SHOPS PLOT, HOTEL, COMMERCIAL & NURSING HOME PLOT ON COMMERCIAL (COM-2) PLOT & COMMERCIAL/RESIDENTIAL (C/G.H.-1) PLOT IN POCKET C, MADHUBAN BAPUDHAM YOJNA GHAZIABAD

TOTAL AREA OF LAND	= 60938.57 SQ.M.
AREA UNDER SHOPS PLOT	= 21632.30 SQ.M.
AREA UNDER HOTEL	= 1788.72 SQ.M.
AREA UNDER NURSING HOME	= 1308.58 SQ.M.
AREA UNDER COMMERCIAL	= 1154.00 SQ.M.
AREA UNDER MULTILEVEL P.	= 5468.95 SQ.M.
AREA UNDER TOILET /D.W.	= 322.60 SQ.M.
AREA UNDER GREEN/CENTRAL PLAZA	= 7877.60 SQ.M.
AREA UNDER CAR PARKING	= 2824.32 SQ.M.
AREA UNDER PAVED PATHWAY	= 18561.50 SQ.M.
TOTAL NOS. OF CAR IN CAR PARKING	- 185

SHOPS PLOT - 10.00M. X 28.15M.	- 281.50 SQ.M.	- 10 (C/S.P.-06 TO C/S.P.-15)
SHOPS PLOT - 10.00M. X 20.00M.	- 200.00 SQ.M.	- 38 (C/S.P.-50 TO C/S.P.-64, C/S.P.-89 TO C/S.P.-111)
SHOPS PLOT - 09.00M. X 18.00M.	- 162.00 SQ.M.	- 39 (C/S.P.-01 TO C/S.P.-05, C/S.P.-16 TO C/S.P.-49)
SHOPS PLOT - 08.00M. X 12.50M.	- 100.00 SQ.M.	- 47 (C/S.P.-65 TO C/S.P.-88, C/S.P.-112 TO C/S.P.-134)
TOTAL NOS. OF SHOPS PLOT		- 134

SHOPS PLOT
 F.A.R = 3 - G.F.L., F.F. & S.F. (AS PER CONTROL DRG.)
 (BASEMENT AREA IS FREE FORM EAR.)
 GROUND COVERAGE = 100 %

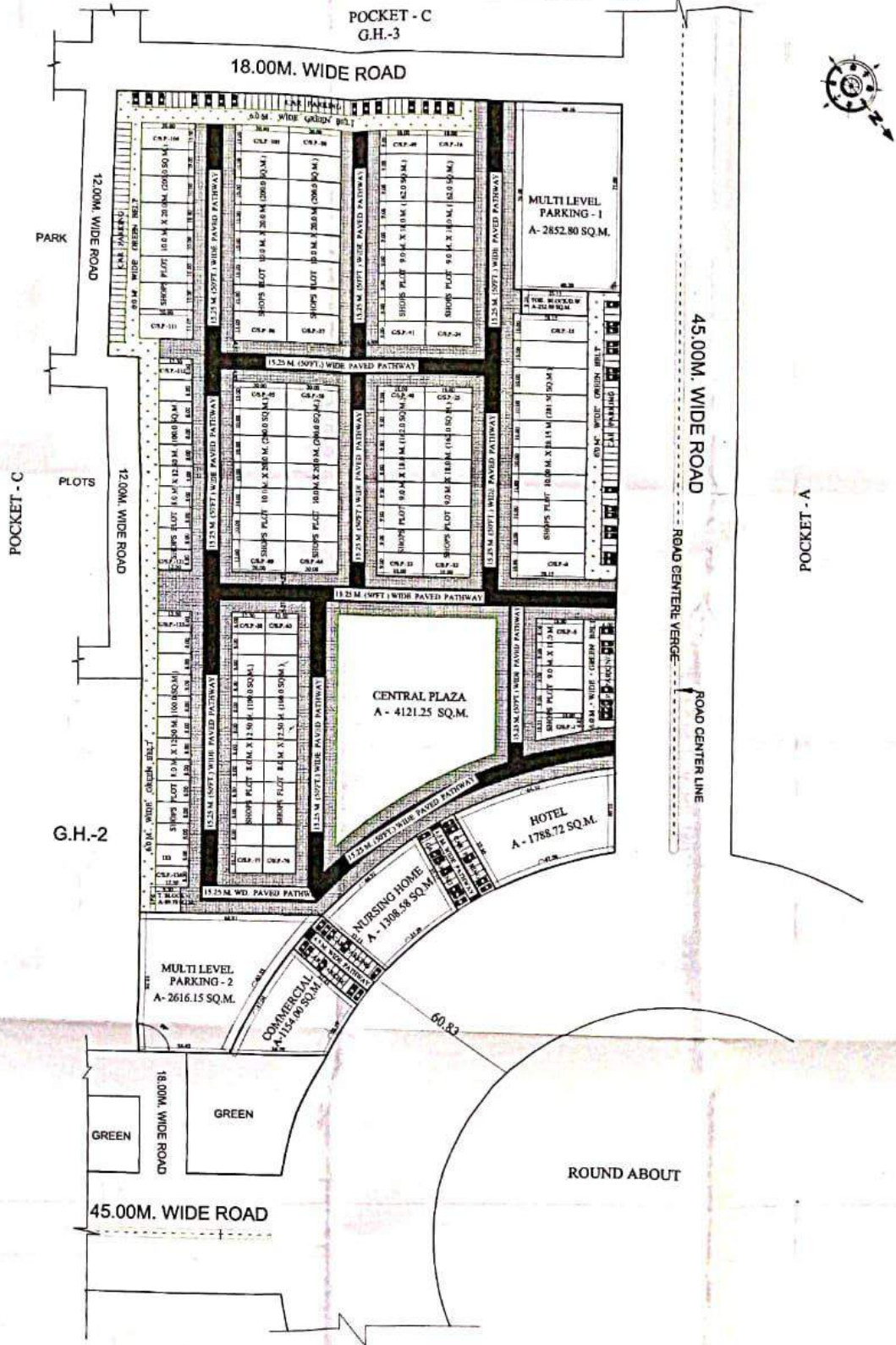

REVISED PART LAYOUT PLAN OF COMMERCIAL PLOT C-1/1 TO C-1/16 & GROUP HOUSING PLOT GH-4 AT, KOYAL ENCLAVE SCHEME, LONI, G.D.A. GHAZIABAD

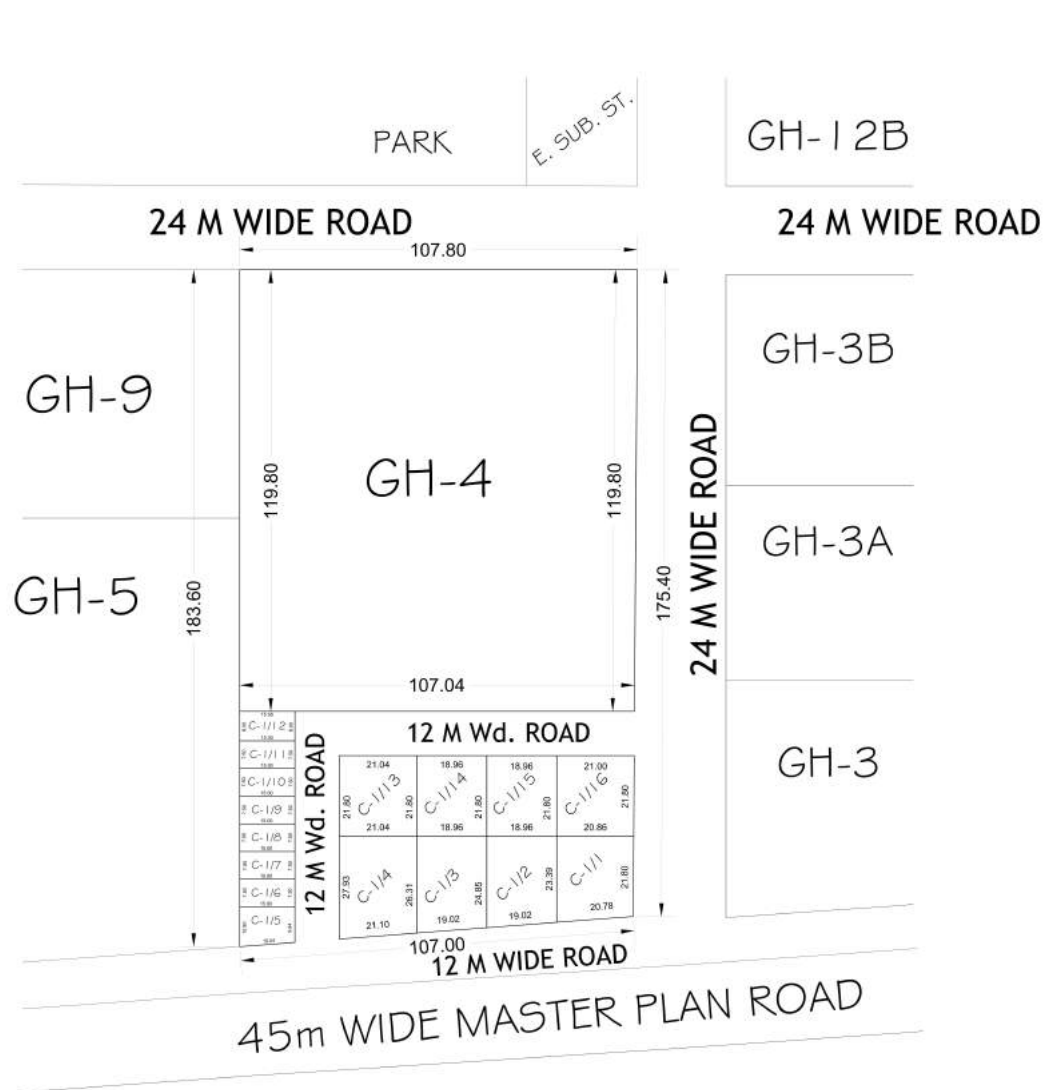

COMMERCIAL PLOTS
GROUND COVERAGE - 50%
F.A.R. - 1.75

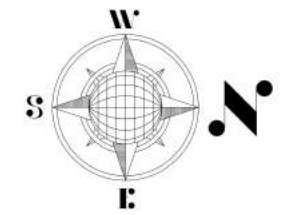

AREA SCHEDULE	
PLOT No.	AREA (IN Sqmt.)
C-1/1	469.78
C-1/2	457.36
C-1/3	485.00
C-1/4	570.61
C-1/5	153.40
C-1/6 to C-1/11	112.50
C-1/12	120.00
C-1/13	458.71
C-1/14 & C-1/15	413.32
C-1/16	456.29
GH-04	12867.54

COMMERCIAL SET BACK	
BELOW 200.00 Sqmt.	ABOVE 200.00 Sqmt.
FRONT - 3.00 Sqmt.	FRONT - 4.50 Sqmt.
REAR - 3.00 Sqmt.	REAR - 3.00 Sqmt.
	SIDE - 3.00 Sqmt.
	SIDE - 3.00 Sqmt.

GHAZIABAD DEVELOPMENT AUTHORITY

REVISED PART LAYOUT PLAN OF GROUP HOUSING PLOT No. - GH 5 & 6, AT KOYAL ENCLAVE SCHEME, LONI, GHAZIABAD

AREA SCHEDULE

GROUP HOUSING PLOT GH - 5, 6 = 24143.46 Sqmt.

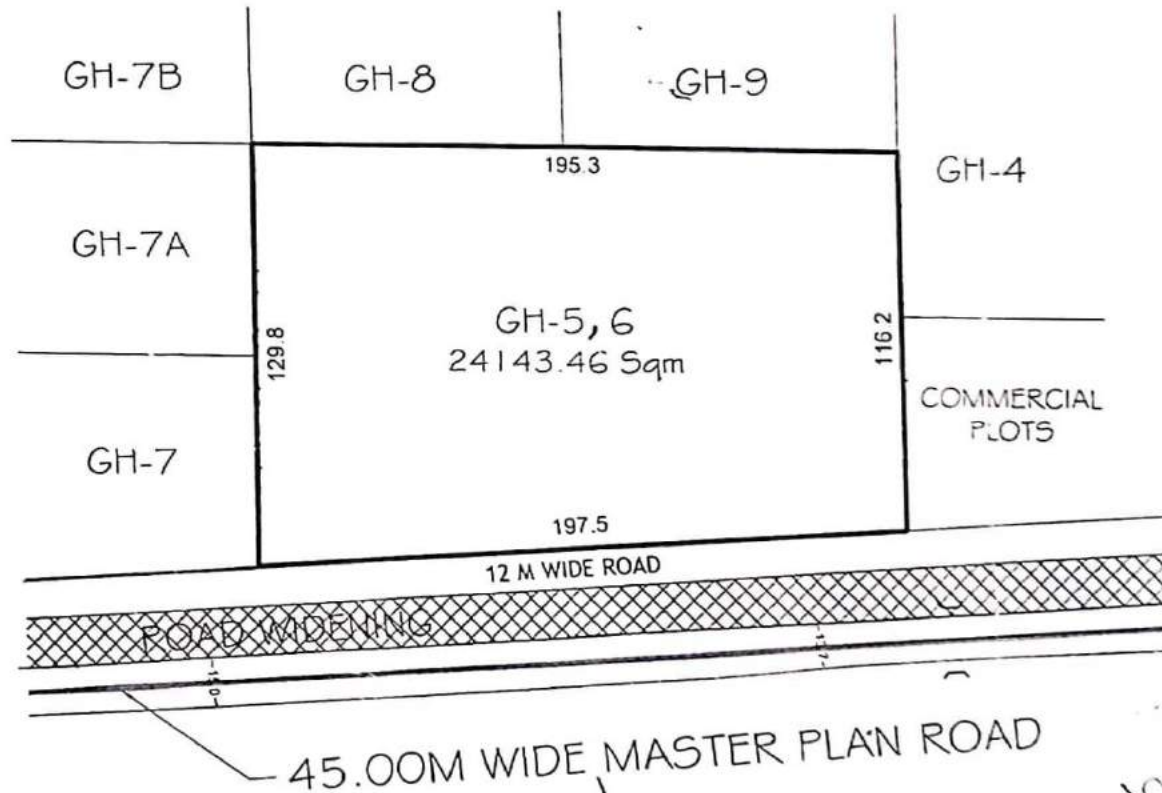

1/2022
AMIN

JUNIOR ENGINEER

ASSISTANT ENGINEER

EXECUTIVE ENGINEER

TOWN PLANNER

TOWN PLANNER

C.A.T.P.

SECRETARY







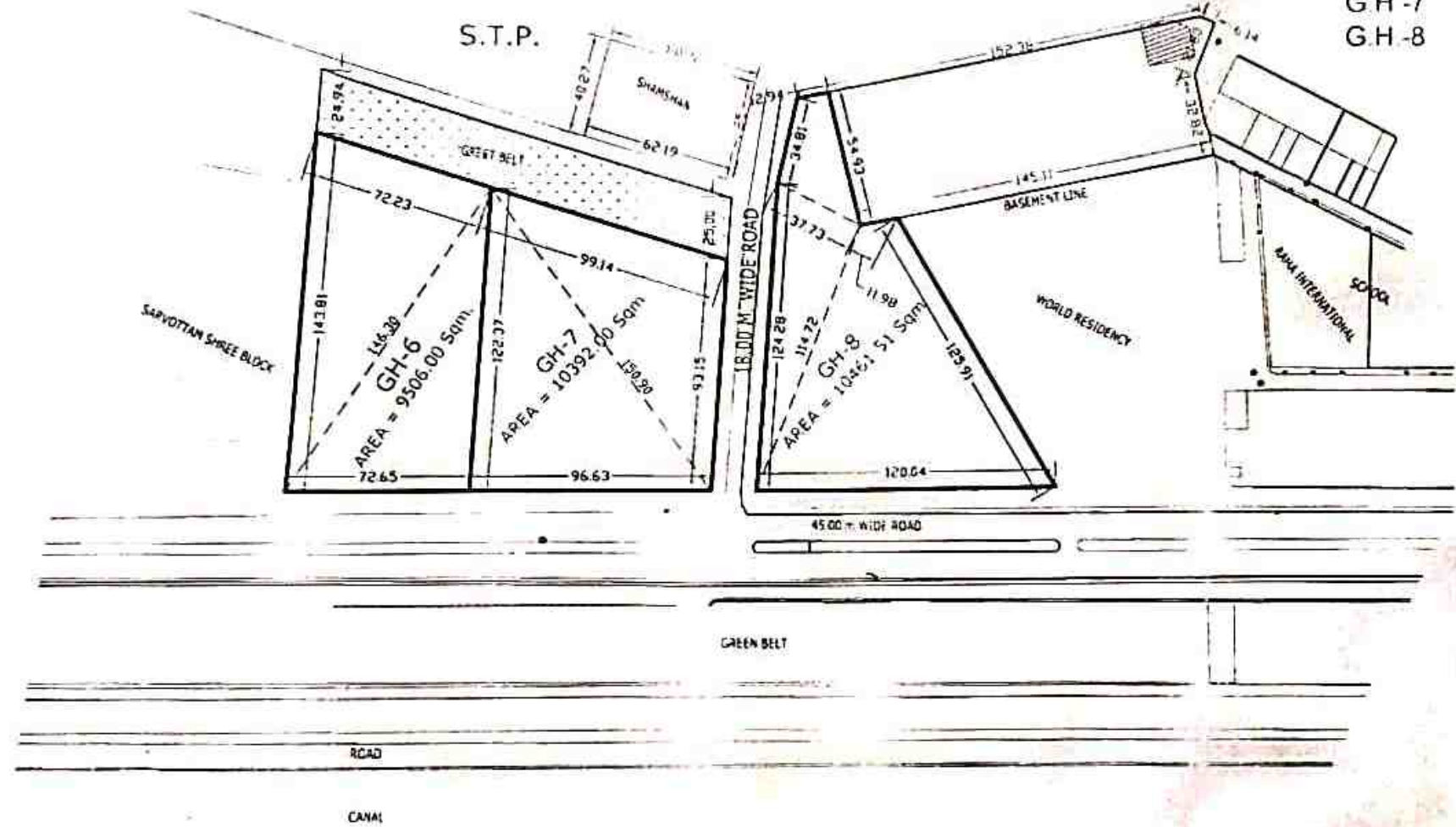

VICE CHAIRMAN

REV. PART LAYOUT PLAN OF G.H.-6, GH-7 & G.H.-8 AT INDIRAPURAM EXT.

AREA CHART

G.H.-6	9506.00 Sqmt.
GH-7	10392.00 Sqmt.
G.H.-8	10461.51 Sqmt.

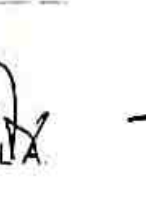

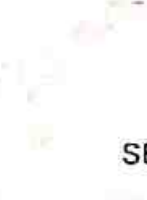
 MAN
 AMIN
 JE
 AE
 F
 TEH-LA
 TP
 CATP
 SECRETARY

PROP. SITE PLAN OF PLOT NO.GK-III/101 INDIRAPURAM GZB.

PLOT AREA GK-III/101 - 117.20 SQ.M.



EXIST.
PLOT
NO.=92

EXIST.
PLOT
NO.=100

ENCROACHMENT
(DISPUTED LAND)

PLOT
NO.=101

15.00

17.59

13.60

4.00

11.00

7.5 MT. WIDE ROAD

25/11/15
D/MAN

30/11/2015
J.E.

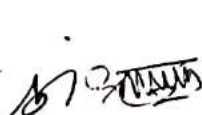
A.E. Amin

E.E. TLA T.P.

E.A.T.P.



15/11/15
SECY.

V.C.

PROPOSED SITE PLAN FOR HEALTHCARE HUB AND MUSICAL FOUNTAIN & MULTI MEDIA SHOW AREA - SHOW POCKET-E MADHUBAN BAPUDHAM YOJNA; GZB.

HEALTH CARE HUB AREA - 30484.50 SQ.M.

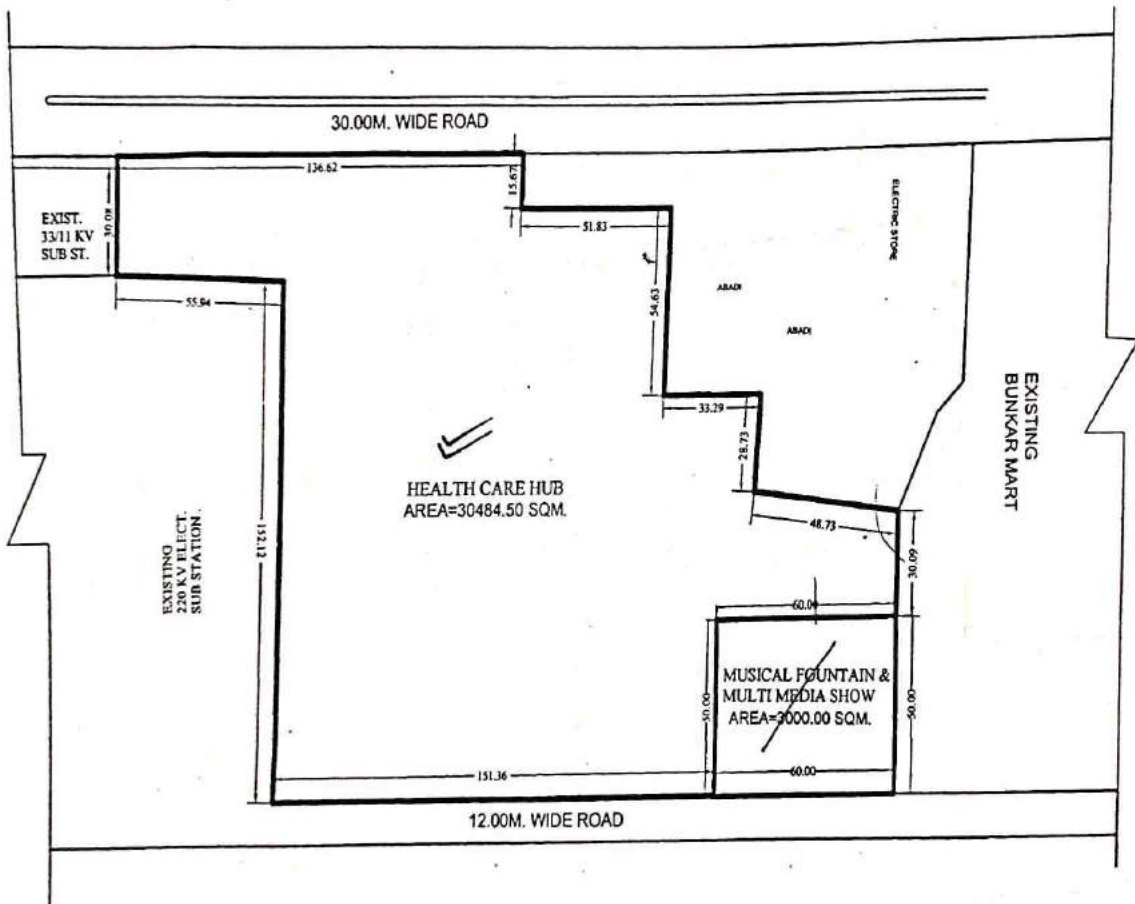
MUSICAL FOUNTAIN AND MULTIMEDIA SHOW AREA - 3000.00 SQ.M.



16-11-19
D/Man AMIN

19-11-19
J.E.

A.E. E.E.

DSD/G-2-31
T.P.(R)

T.P.(R)

T.D.(K)

SECRETARY

VICE CHAIRMAN

SITE PLAN OF COMMERCIAL PLOT No. H - AT INDRAPRASTHA SCHEME, POCKET - H, LONI, GHAZIABAD



<<< TO LONI
 CENTRE LINE OF ROAD
 TO BHOPURA >>>

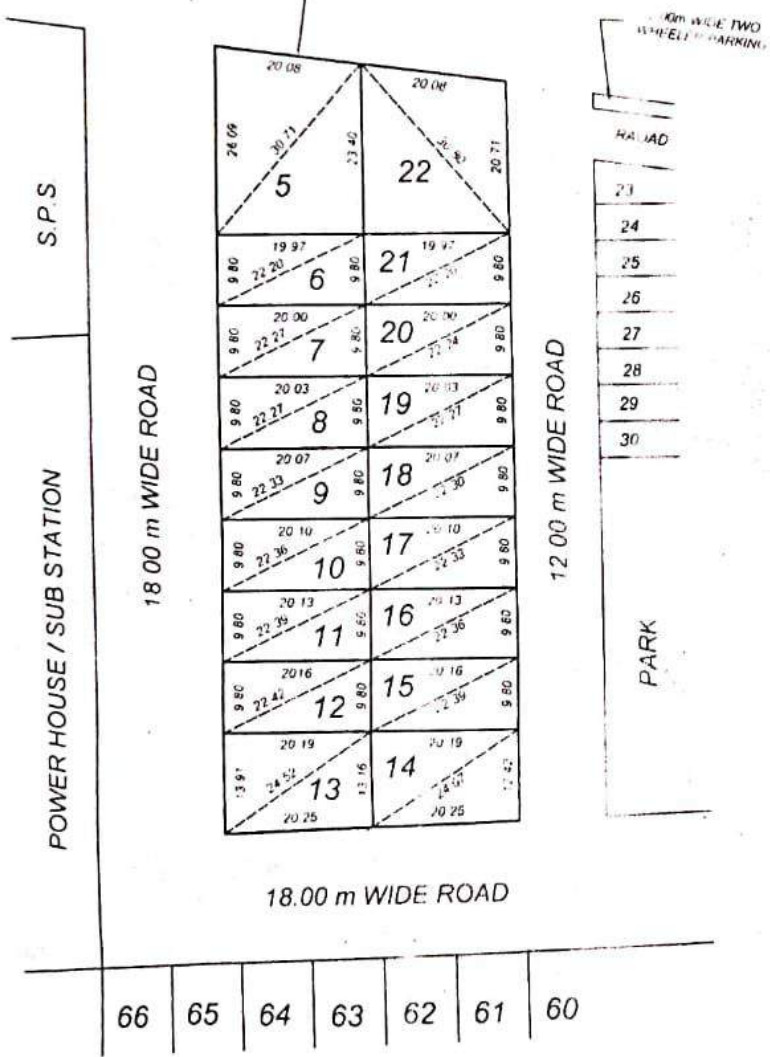

AREA SCHEDULE	
PLOT No.	AREA (In Sqmt.)
H-5	493.21
H-6	195.98
H-7	196.27
H-8	196.49
H-9	196.96
H-10	197.25
H-11	197.55
H-12	197.84
H-13	273.73
H-14	258.54
H-15	197.84
H-16	197.55
H-17	197.25
H-18	196.96
H-19	196.49
H-20	196.27
H-21	195.98
H-22	439.89

20/2/21
 Prepared By

20-02-21
 Compared By

Sr. 12-02-2021
 PANCHI A.
 Measured & Calc By Jun Engr

Sr. 12-02-2021
 DHARMVEER SINGH
 Asst Engr.

Sr. 12-02-2021
 DHARMVEER SINGH
 S Engr

20/2/21
 T.P. (R)

SITE PLAN OF COMMERCIAL PLOT No. H - AT INDRAPRASTHA SCHEME, POCKET - H, LONI, GHAZIABAD

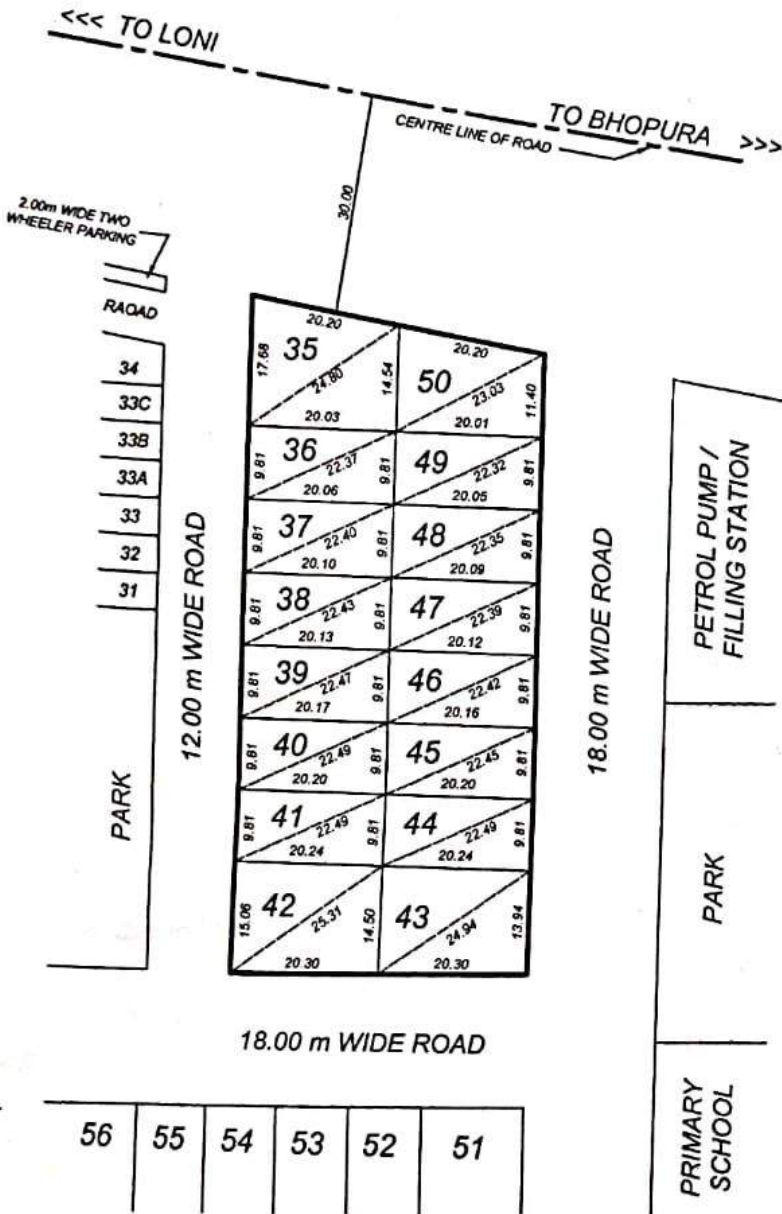

AREA SCHEDULE	
PLOT No.	AREA (In Sqmt)
H-35	322.38
H-36	196.77
H-37	197.24
H-38	197.52
H-39	197.93
H-40	198.14
H-41	198.36
H-42	299.82
H-43	288.18
H-44	198.36
H-45	197.95
H-46	197.84
H-47	197.36
H-48	197.15
H-49	196.50
H-50	259.36

[Signature]
20/2/21
Prepared By.

[Signature]
20-02-21
Compared By.

Sd. - 12-02-2021
PANCHI LAL
Measured & Calc. By. Jun. Engr.

Sd. - 12-02-2021
DHARMVEER SINGH
Astt. Engr.

Sd. - 12-02-2021
DHARMVEER SINGH
S. Engr.

[Signature]
20/2/21
T.P. (R)





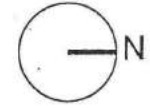

46

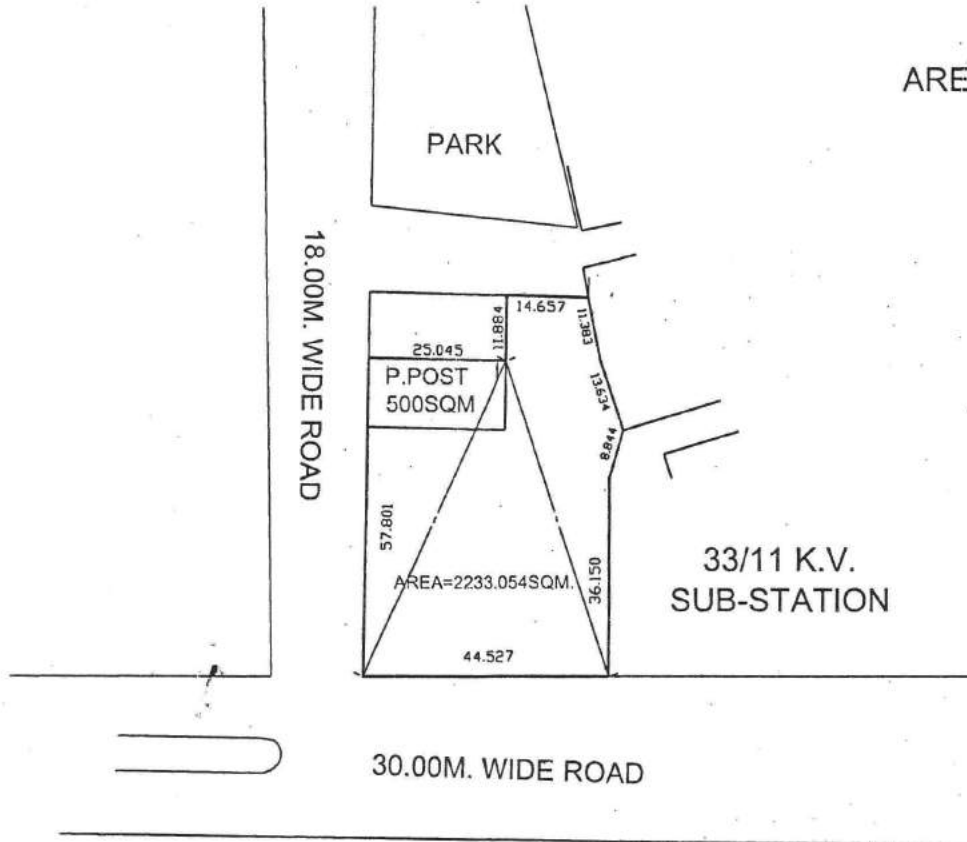
SITE PLAN OF PLOT FOR OLD AGE HOME AT KARPOORI PURAM

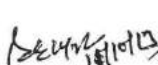
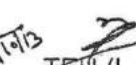
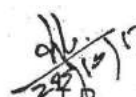

AREA OF PLOT = 2233.05 SQM



 PREPARED BY. AMIN
 MEASURED BY. J.E.
 A.E.
 E.E.
 T.E. (L.A.)
 T.P.
 C.A.T.P.
 SECY.
 V.C.

SITE PLAN OF RESIDENTIAL PLOT No. - K-1, GROUP HOUSING (GH) No. - 1, 1A & 10, PRIMARY / NURSURY (P/N) No. - 1 & FILLING STATION AT KOYAL ENCLAVE SCHEME, LONI, GHAZIABAD

AREA SCHEDULE

RESIDENTIAL PLOT No.K-1	= 1265.00 Sqm.
FILLING STATION	= 2500.00 Sqm.
GROUP HOUSING (G.H.) No.-1	= 8565.00 Sqm.
GROUP HOUSING (G.H.) No.-1A	= 6958.00 Sqm.
GROUP HOUSING (G.H.) No.-10	= 7140.00 Sqm.
PRIMARY / NURSURY (P/N) No.-1	= 3726.00 Sqm.

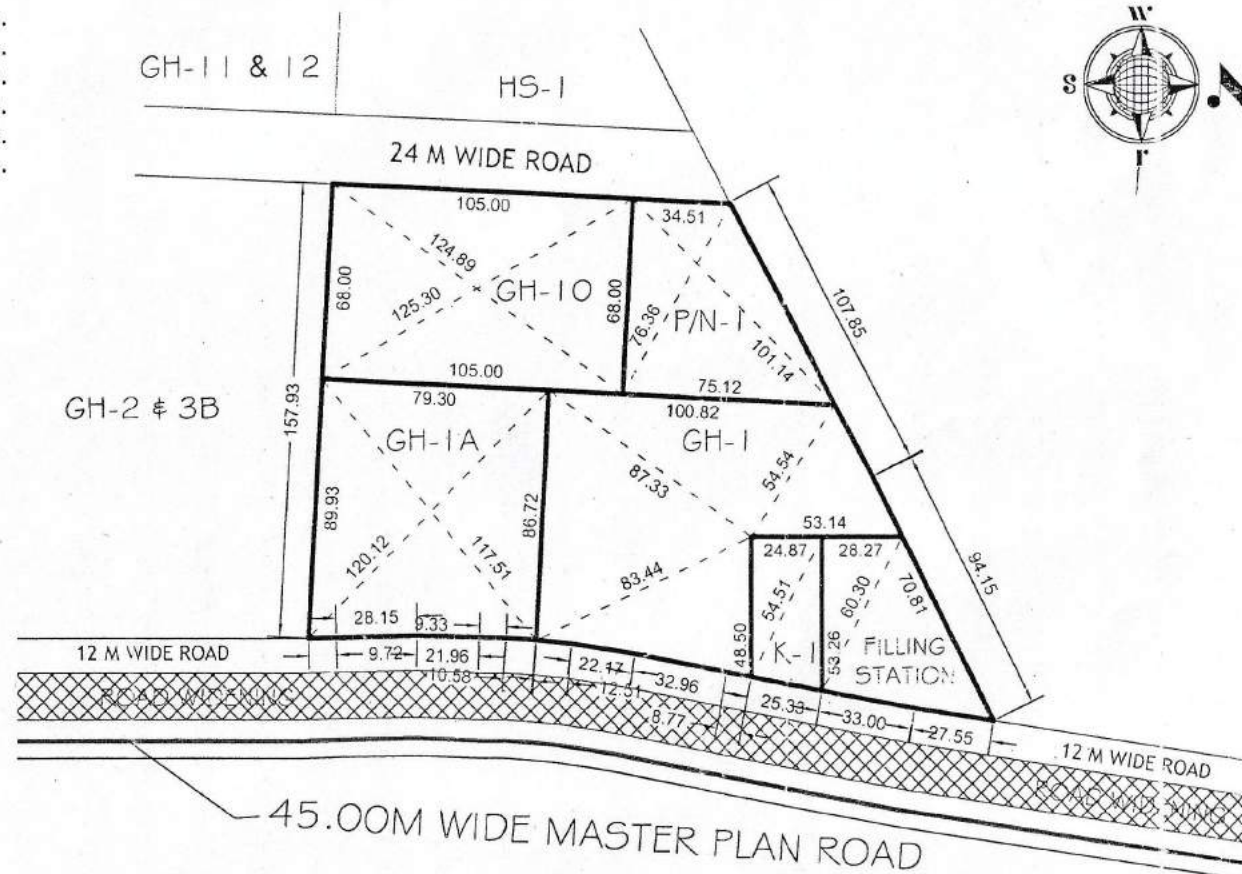

[Signature]
NITIN KUMAR
D/Man

[Signature]
ANAND SWAMI
AMIN

[Signature]
R. K. KAUSHIK
JUNIOR ENGINEER

[Signature]
NARENDRA KUMAR
ASSISTANT ENGINEER

[Signature]
R.K. JAISWAL
EXECUTIVE ENGINEER

[Signature]
RAJKUMAR MITTAL
TEHSILDAR (L.A.)

[Signature]
JYOTI PRASAD
TOWN PLANNER

[Signature]
ISTIYAQ AHMED
CA 79

[Signature]
RAVINDRA GODSOLE
SECRETARY

[Signature]
VIJAY KUMAR GOYAL
VICE CHAIRMAN

PLAN OF GROUP HOUSING (GH) No. - 3, 3A & 3B AT KOYAL ENCLAVE SCHEME, LONI, GHAZIABAD

AREA SCHEDULE

GROUP HOUSING (G.H.) No.-3	= 5994.08 Sqm.
GROUP HOUSING (G.H.) No.-3A	= 5268.84 Sqm.
GROUP HOUSING (G.H.) No.-3B	= 5766.84 Sqm.

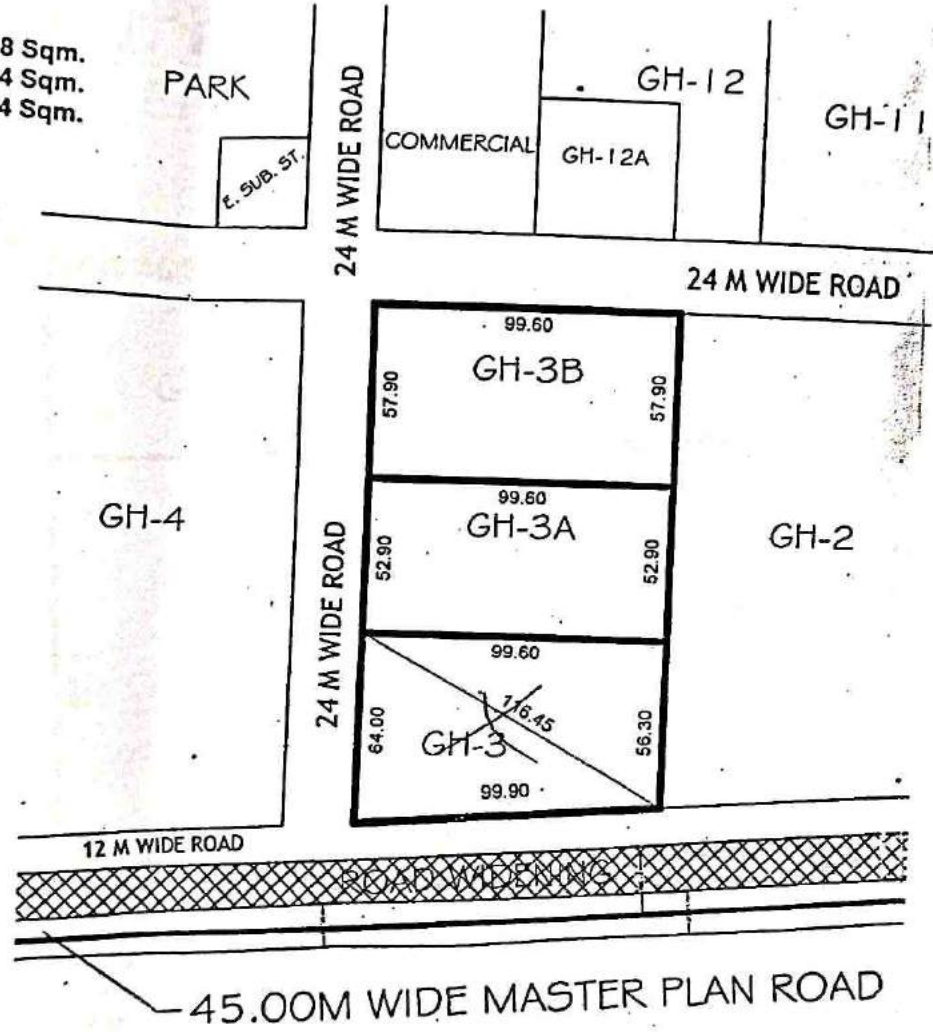

PRODUCED BY AN AUTODESK EDUCATIONAL PRODUCT

[Signature]
13/02/14
N. KUMAR
MAN

[Signature]
R.K. KAUSHIK
JUNIOR ENGINEER

[Signature]
KAPTAN BINGH
EXECUTIVE ENGINEER

[Signature]
R.K. JAISWAL
EXECUTIVE ENGINEER

[Signature]
JYOTI PRASAD
TOWN PLANNER

[Signature]
S. SAUR
C.A.T.P.

[Signature]
RAVINDRA GODBOLE
SECRETARY

[Signature]
SANJAY KUMAR YADAV
VICE CHAIRMAN

शुद्ध मी. के अक्षर में सूची में सम्मक - 6

PRODUCED BY AN AUTODESK EDUCATIONAL PRODUCT

REVISED SITE PLAN OF HS-2 AT KOYAL ENCLAVE SCHEME, LONI, GHAZIABAD

AREA SCHEDULE

HIGHER SECONDRY-2 (H/S-2) = 6395.00 Sqmt.
 GROUND COVERAGE = 30 %
 PERMISSIBLE F.A.R. = 1.00

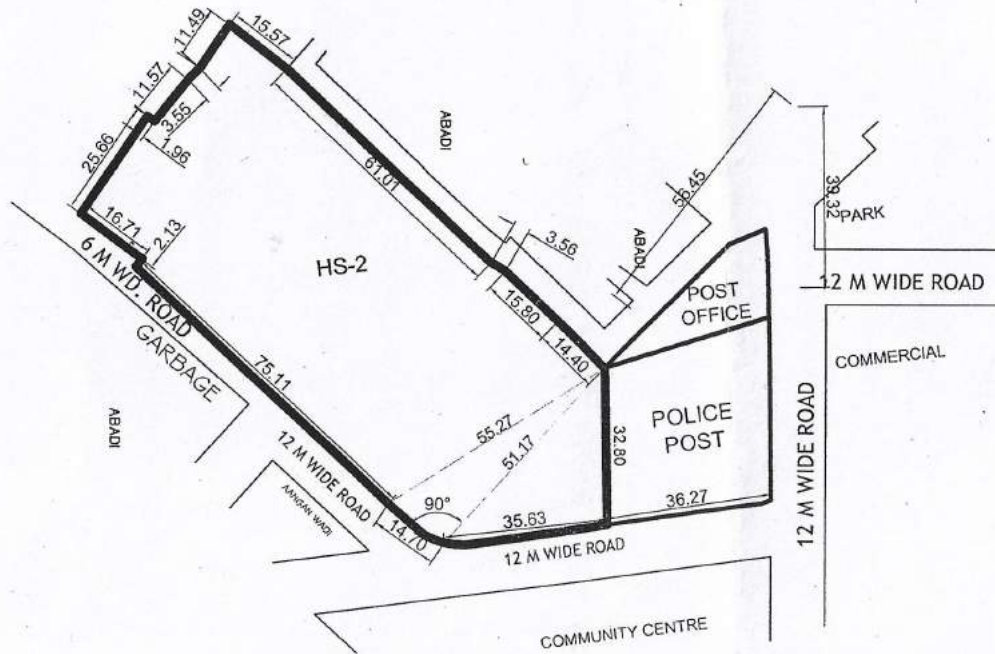

[Signature]
lan
[Signature]
27/11/2020
JUN. ENGR.
[Signature]
27.11.20
ASTT. ENGR.
[Signature]
S. ENGR.
[Signature]
T. P. (R)
[Signature]
T. P. (K)
[Signature]
SECRETARY
[Signature]
VICE CHAIRMAN

SITE PLAN OF RESIDENTIAL PLOT No. - K-1, GROUP HOUSING (GH) No. - 1, 1A & 10, PRIMARY / NURSURY (P/N) No. - 1 & FILLING STATION AT KOYAL ENCLAVE SCHEME, LONI, GHAZIABAD

AREA SCHEDULE

RESIDENTIAL PLOT No.K-1	= 1265.00 Sqm.
FILLING STATION	= 2500.00 Sqm.
GROUP HOUSING (G.H.) No.-1	= 8565.00 Sqm.
GROUP HOUSING (G.H.) No.-1A	= 6958.00 Sqm.
GROUP HOUSING (G.H.) No.-10	= 7140.00 Sqm.
PRIMARY / NURSURY (P/N) No.-1	= 3726.00 Sqm.

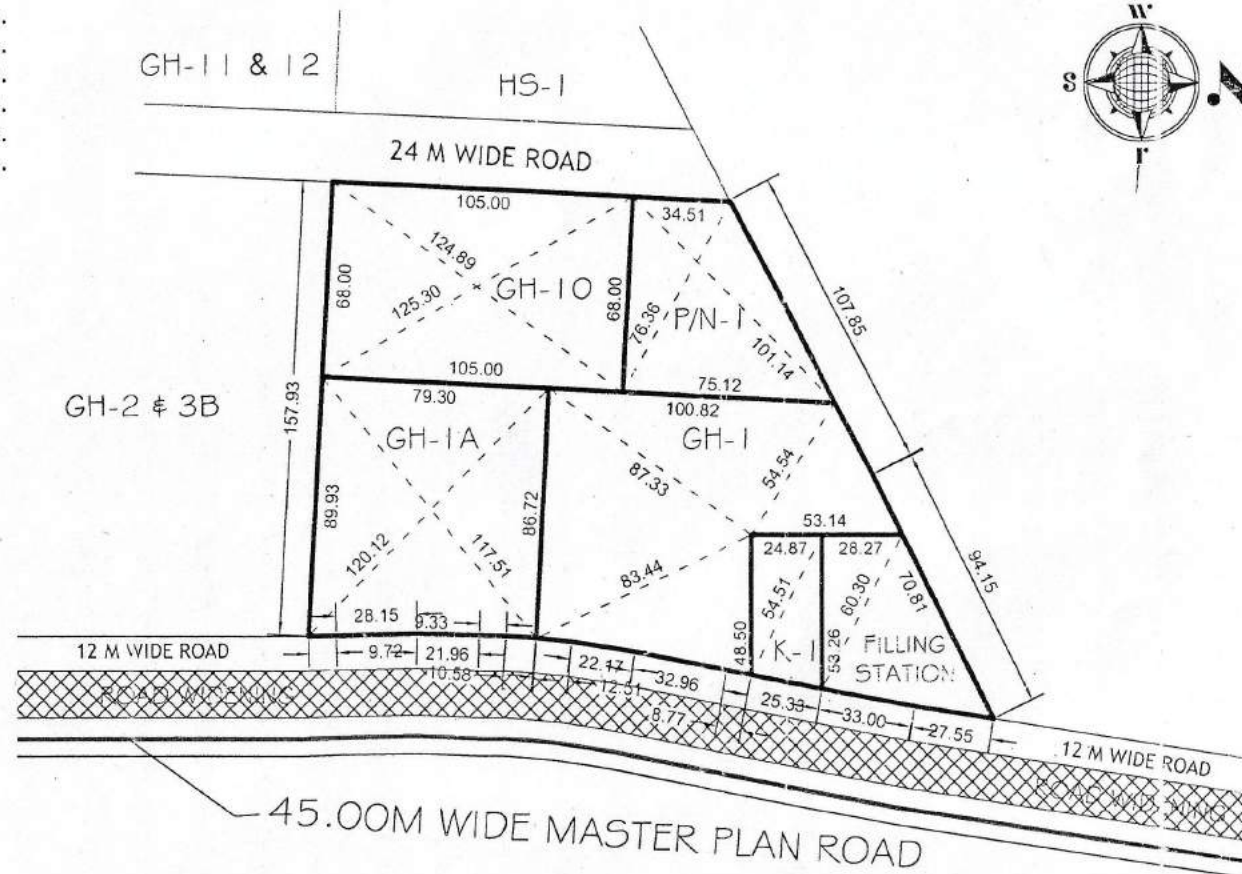

[Signature]
NITIN KUMAR
D/Man

[Signature]
ANAND SWAMI
AMIN

[Signature]
R. K. KAUSHIK
JUNIOR ENGINEER

[Signature]
NARENDRA KUMAR
ASSISTANT ENGINEER

[Signature]
R.K. JAISWAL
EXECUTIVE ENGINEER

[Signature]
RAJKUMAR MITTAL
TEHSILDAR (L.A.)

[Signature]
JYOTI PRASAD
TOWN PLANNER

[Signature]
ISTIYAQ AHMED
CA 79

[Signature]
RAVINDRA GODSOLE
SECRETARY









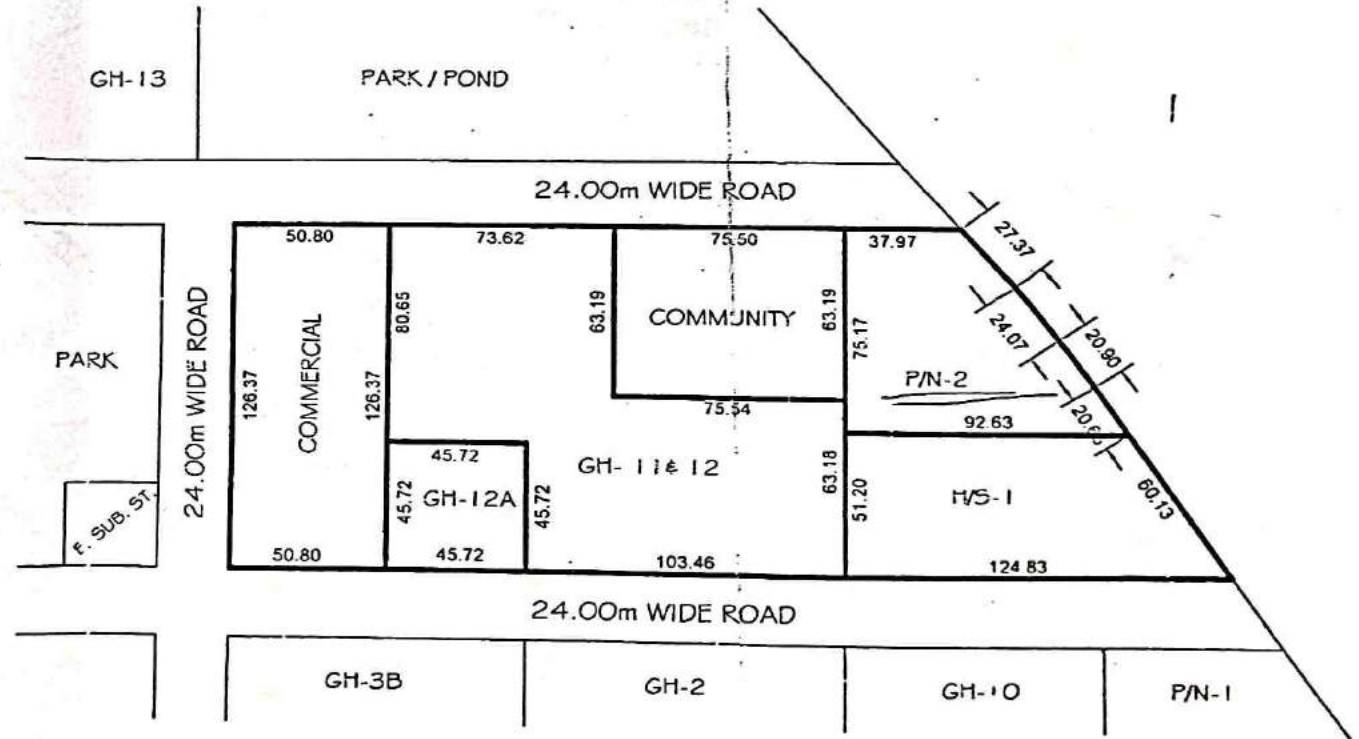

[Signature]
VIJAY KUMAR GOYAL
VICE CHAIRMAN

PLAN OF COMMERCIAL PLOT, GROUP HOUSING (GH) No. - 11 & 12, 12A, PRIMARY / NURSURY (P/N) No. - 2, HIGHER SECONDRY (H.S.) -1, COMMUNITY AT KOYAL ENCLAVE SCHEME, LONI, GHAZIABAD

AREA SCHEDULE

COMMERCIAL PLOT	= 6417.02 Sqm.
GROUP HOUSING (G.H.) No.-12A	= 2090.00 Sqm.
GROUP HOUSING (G.H.) No.-11 & 12	= 11915.26 Sqm.
COMMUNITY	= 4772.00 Sqm.
PRIMARY / NURSURY (P/N) No.-2	= 5011.00 Sqm.
HIGHER SECONDRY (H/S) No.-1	= 5547.00 Sqm.



 **NITIN KUMAR**
 D/Man
 **ANAND SHARMA**
 TANNIN
 **R.K. KAUSHIK**
 JUNIOR ENGINEER
 **NARENDRA KUMAR**
 ASSISTANT ENGINEER
 **RAJENDRA**
 EXECUTIVE ENGINEER
 **RAJKUMAR MITTAL**
 TEHSILDAR (L.A.)
 **JYOTI PRASAD**
 TOWN PLANNER
 **ISTIYAQ AHMED**
 C.A.P.
 **RAVINDRA GODBOLE**
 SECRETARY
 **V.K. GOYAL**
 VICE CHAIRMAN

REVISED PART LAYOUT PLAN OF GROUP HOUSING PLOT OF GH-12B, GH-12C & GH-12D AT KOYAL ENCLAVE SCHEME, LONI, G.D.A. GHAZIABAD.

GROUND COVERAGE - 40%
F.A.R. - 25

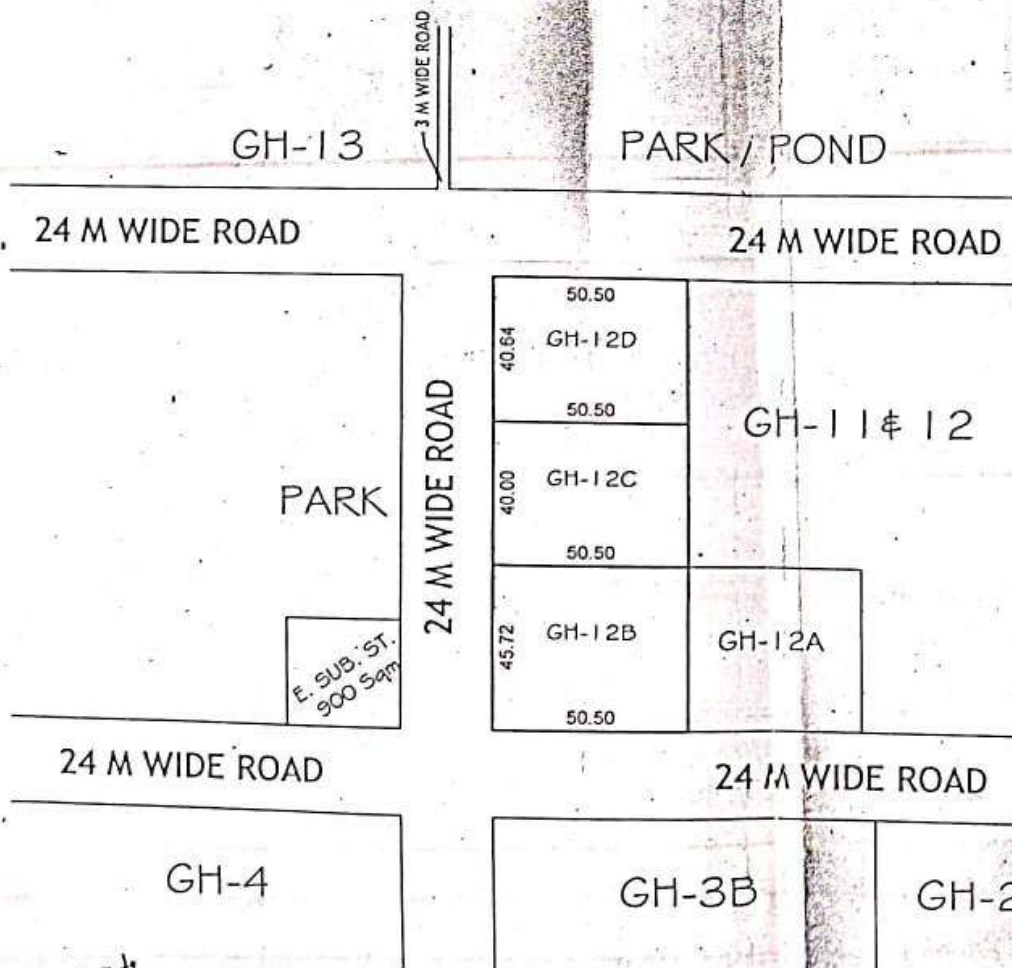

AREA SCHEDULE	
PLOT No.	AREA (In Sqmt.)
GH-12B	2308.86
GH-12C	2020.00
GH-12D	2052.32

[Signature]
26/08/2020
D/MAN

For measurements only.
[Signature]
27/8/2020
JUNIOR ENGINEER

[Signature]
ASSISTANT ENGINEER

[Signature]
SUPERINTENDENT ENGINEER

[Signature]
TOWN PLANNER (R)

[Signature]
TOWN PLANNER (K)

[Signature]
SECRETARY

[Signature]
VICE CHAIRMAN

**SITE PLAN OF KIOSK PLOT NO KP-1 SHAKTI KHAND-4 IN
INDRAPURAM SCHEME G.M.P GHAZIABAD**

TOTAL AREA OF KIOSK PLOT NO = 85.41 SQM.

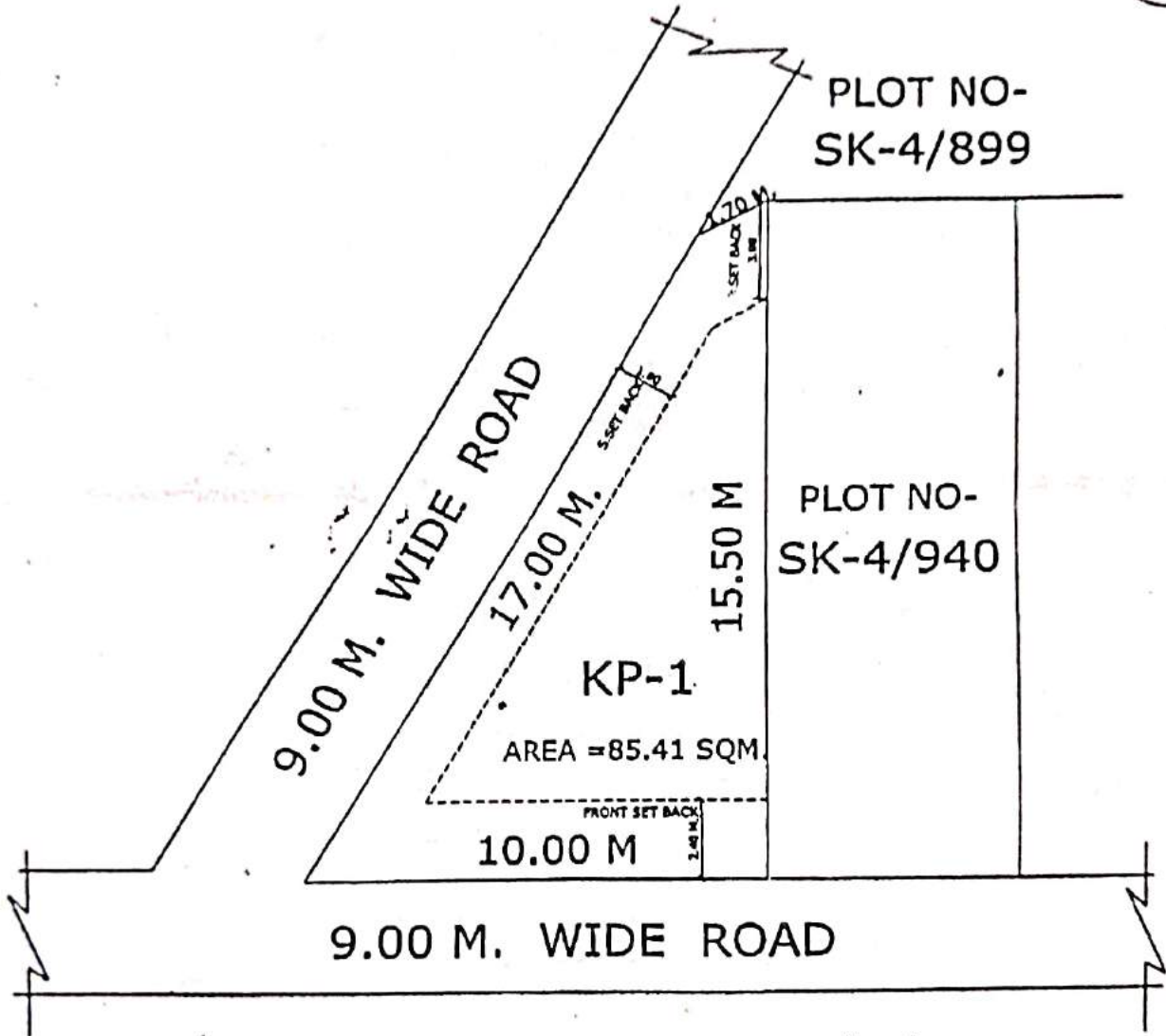

D/M

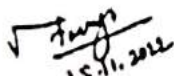

15.11.2012
J.E.

A.E.

E.E.-6

T.P.



C.A.T.P.

SECY.

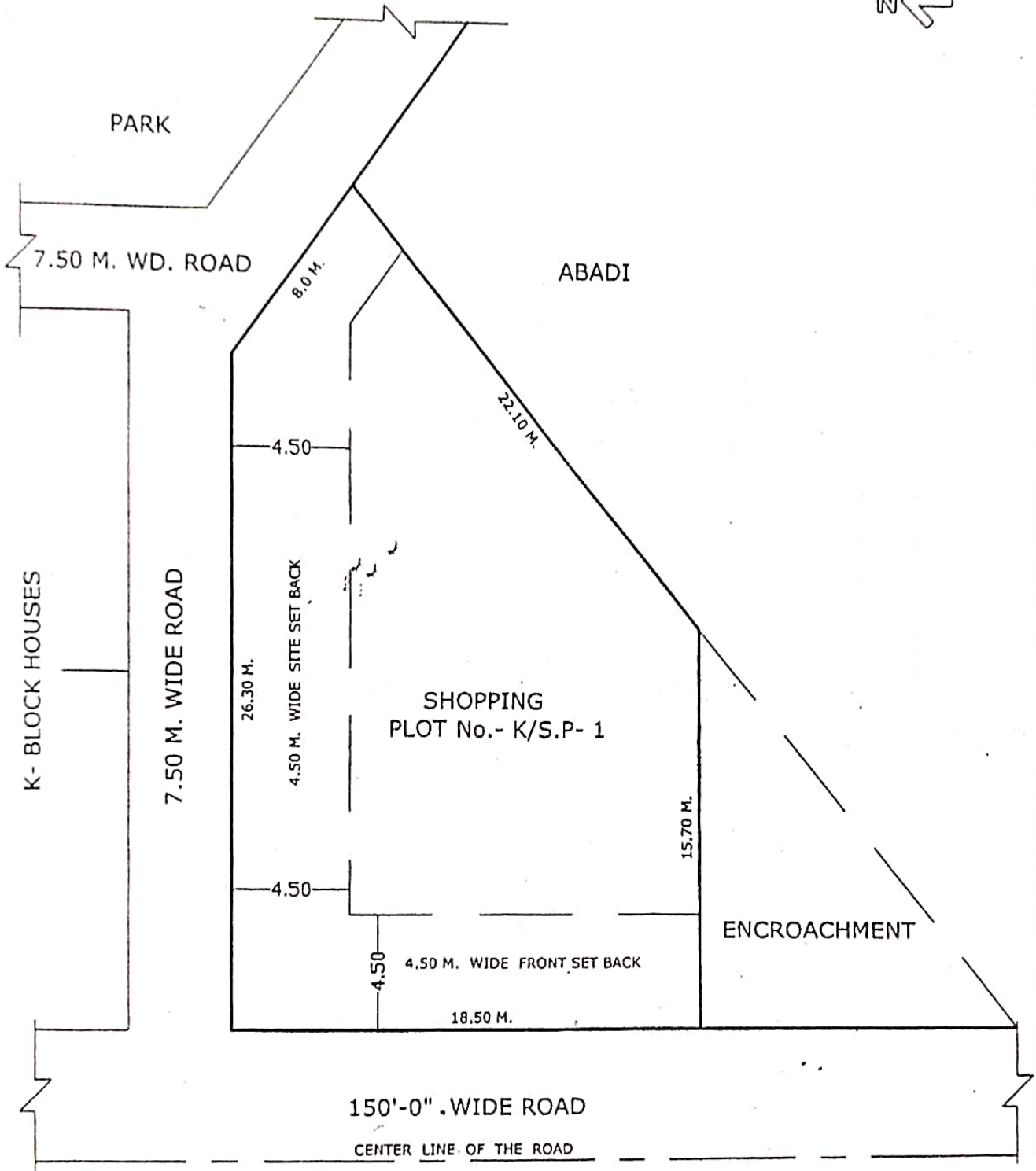

SITE PLAN OF SHOPPING PLOT No.- K/S.P- 1 ON KHASRA No. 490, K- BLOCK AT VILLEGE MIRZAPUR, VIJAY NAGAR, SECTOR- 9, GHAZIABAD.

TOTAL PLOT AREA = 473.45 Sqm.



[Signature]
D/MAN

[Signature]
AMIN

[Signature]
S.E.

[Signature]
A.E.

[Signature]
E.E.

[Signature]
TEH. A.

[Signature]
T.P.

[Signature]
C.A.T.P.

[Signature]
SECY.

[Signature]
V.C.

SITE PLAN OF POLICE CHOWKI PLOT, COMMUNITY CENTER PLOT & PRI. SCHOOL PLOT AT
POCKET-B MADHUBAN BAPUDHAM YOJNA , GDA, GZB.

PRI. SCHOOL PLOT - B/P.S.-1 = 1567.68 SQ.M. ✓

COMM. CENTER PLOT - B/C.C.-1 = 2832.56 SQ.M.

POLICE CHOWKI PLOT - B/P.C.-1 = 3098.30 SQ.M.

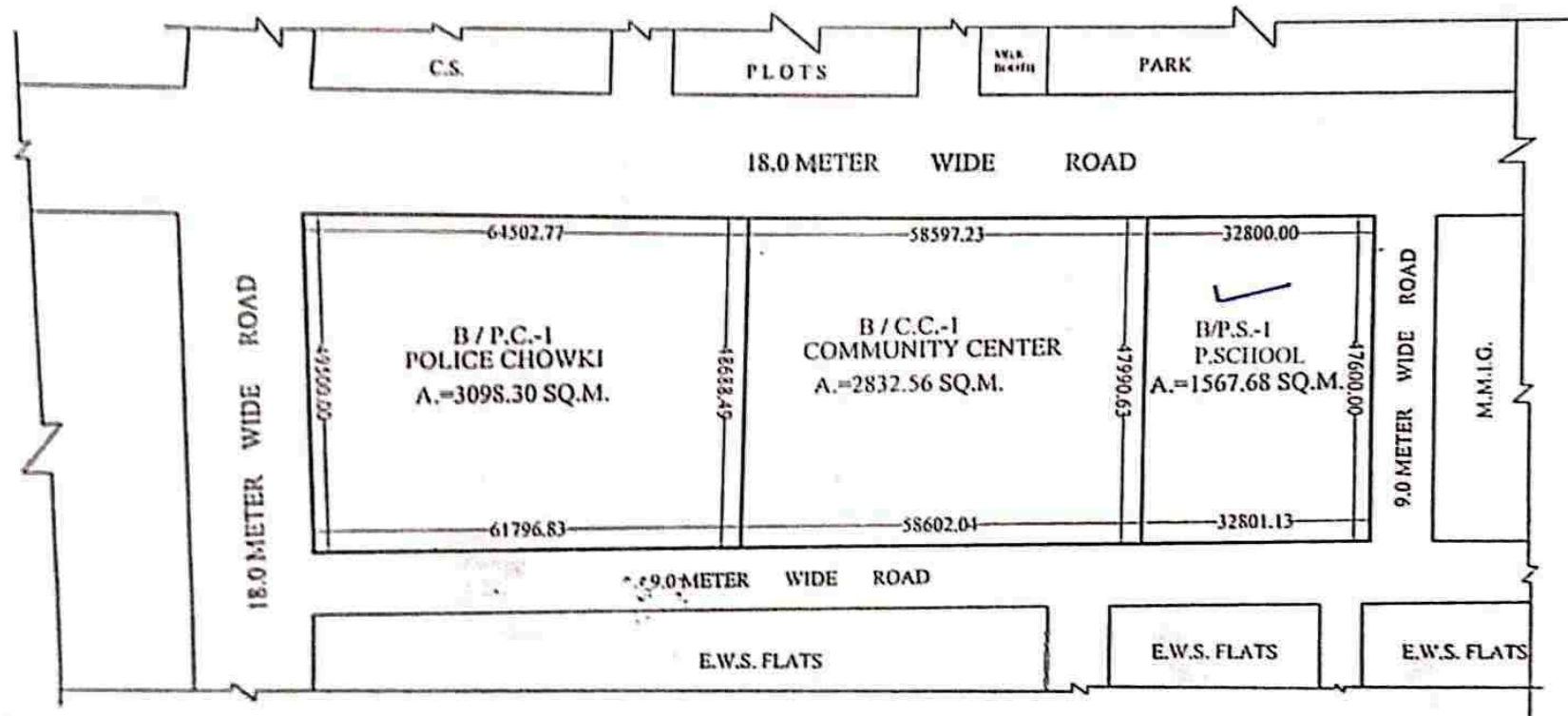

Admani
11-02-21

PREPARED BY

Arund
25/02/21

COMPARED BY

[Signature]
MEAS.&AREA CAL.(J.E.)

[Signature]
A.E.

[Signature]
E.E.

[Signature]
TOWN PLANNER

PLAN OF PRIMARY SCHOOL PLOT NO. D/P.S.-1 AT POCKET 'D' MADHUBAN BAPUDHAM YOJNA; GZB.
AREA OF PRI. SCHOOL D/P.S.-1= 1375.00 SQ.M.

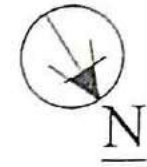
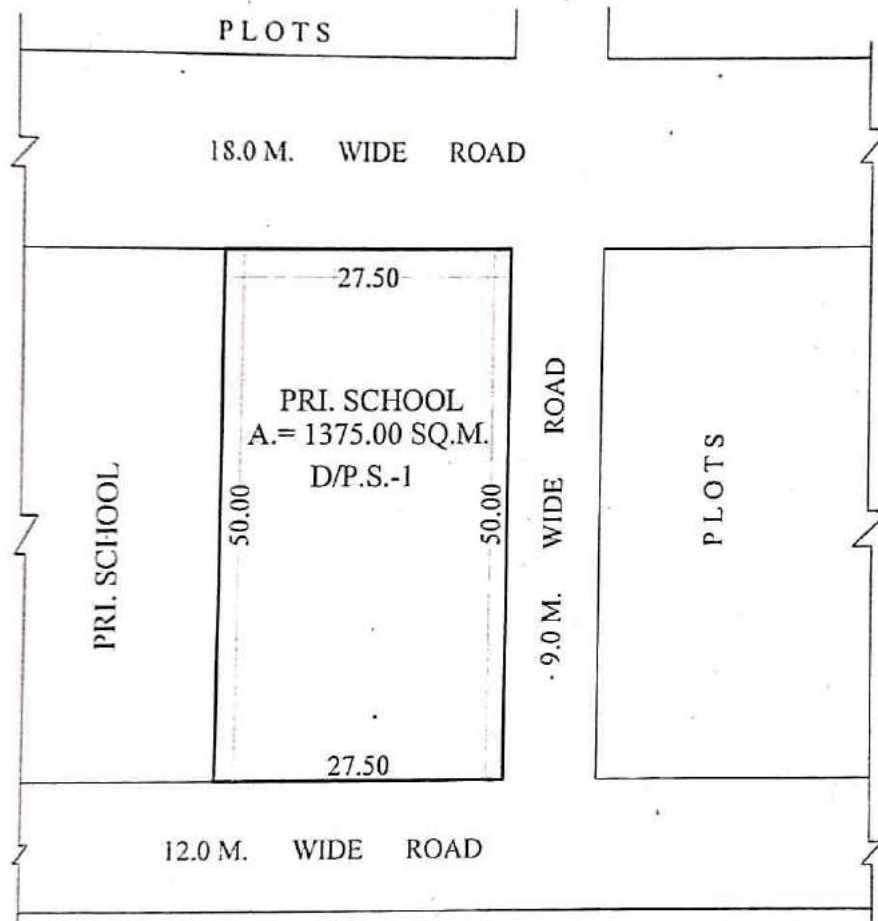

Adnan
06-01-2021
PREPARED BY

Arif
06/01/21
COMPARED BY

Arif
(MEAS. & AREA CAL.) E.

Arif
A.E.

M
E.E.

Arif
T.P.

PROPOSED PART LAYOUT PLAN AT SECTOR VI VAISHALI

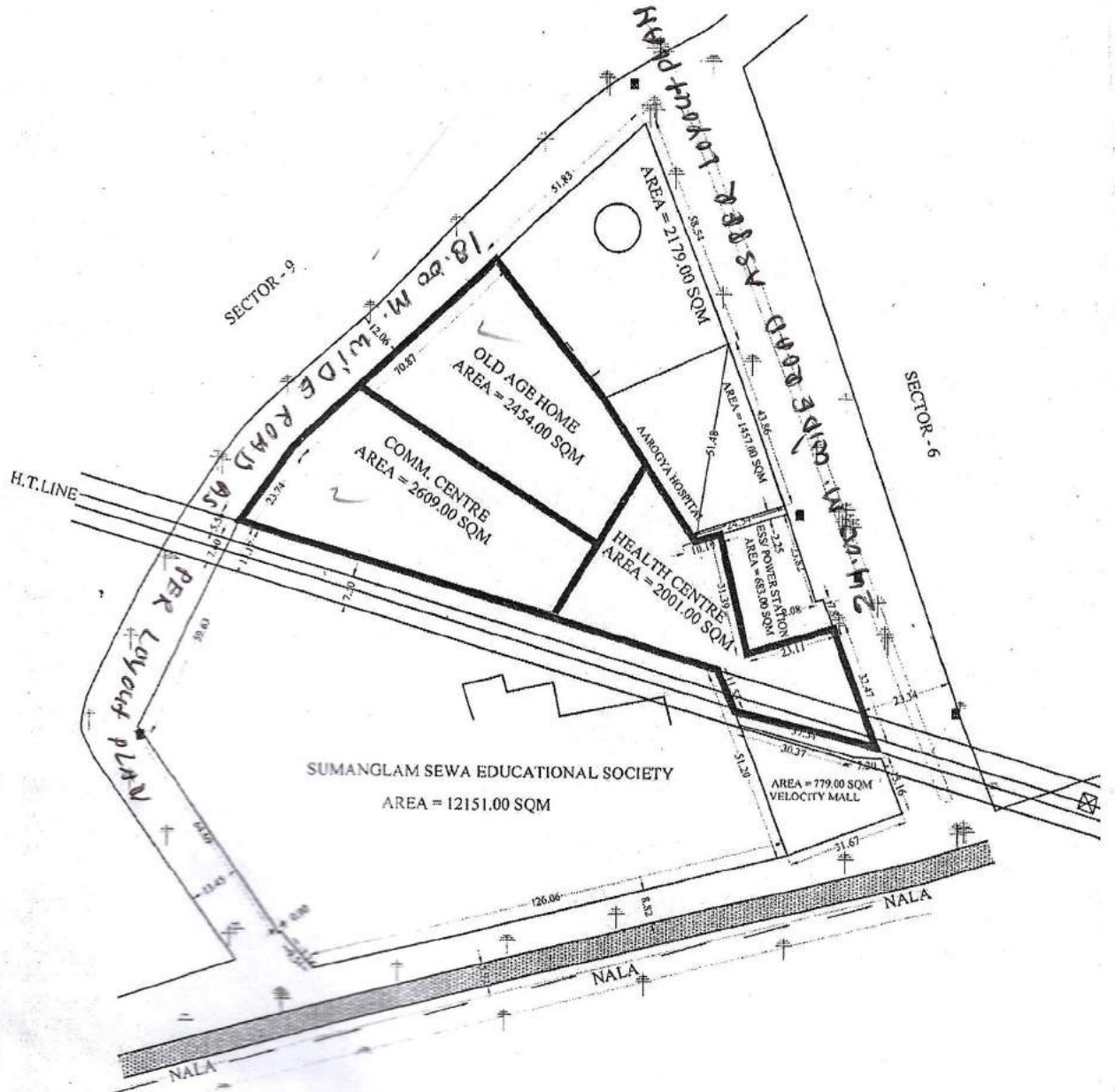

D/MAN

J.E.

AE

E.E.

T.P.

C.A.T.P.

S

PROPOSED SITE FOR NURSING HOSTEL PLOT NO. E/N.HS.-1 IN POCKET-E, AT MADHUBAN BAPUDHAM YOJNA.G.D.A. GZB.

AREA OF NURSING HOSTEL PLOT NO. E/N.HS.-1 = 10408.59 SQ.M.

21/11/2020 2/205

S.No - 14

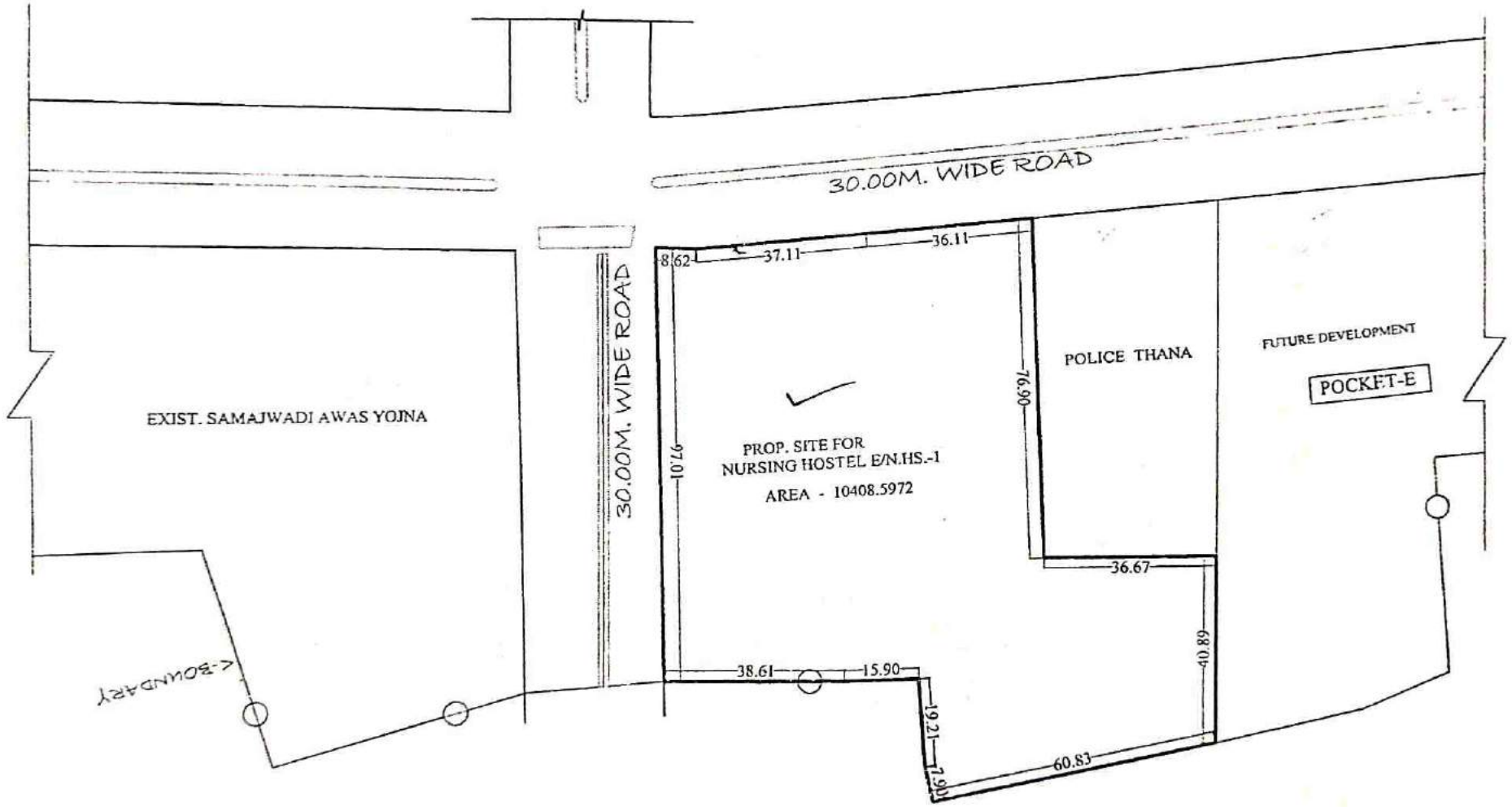

Tentative Site Plan

21/11/2020
21/11/2020
AMIN

JE

OSD-LA

EF

T.P.(R)

T.P.(K)

SECRETARY

VICE CHAIRMAN

**SITE PLAN OF BANK PLOT NO. B/BK-1 & B/BK-2 AT B-BLOCK
SECTOR - XI GMP PRATAP VIHAR GZB..**

AREA OF PLOT NO. B/BK-1 - 274.505 SQ.M.
AREA OF PLOT NO. B/BK-2 - 274.505 SQ.M.



USEAGE :

BASEMENT - PARKING
GROUND FL.- COMM/ ~~OFF~~
FIRST FL. - BANK
SECOND FL. - COMM. / OFF.

GR. COV. - 40%
FA.R. - 1.20

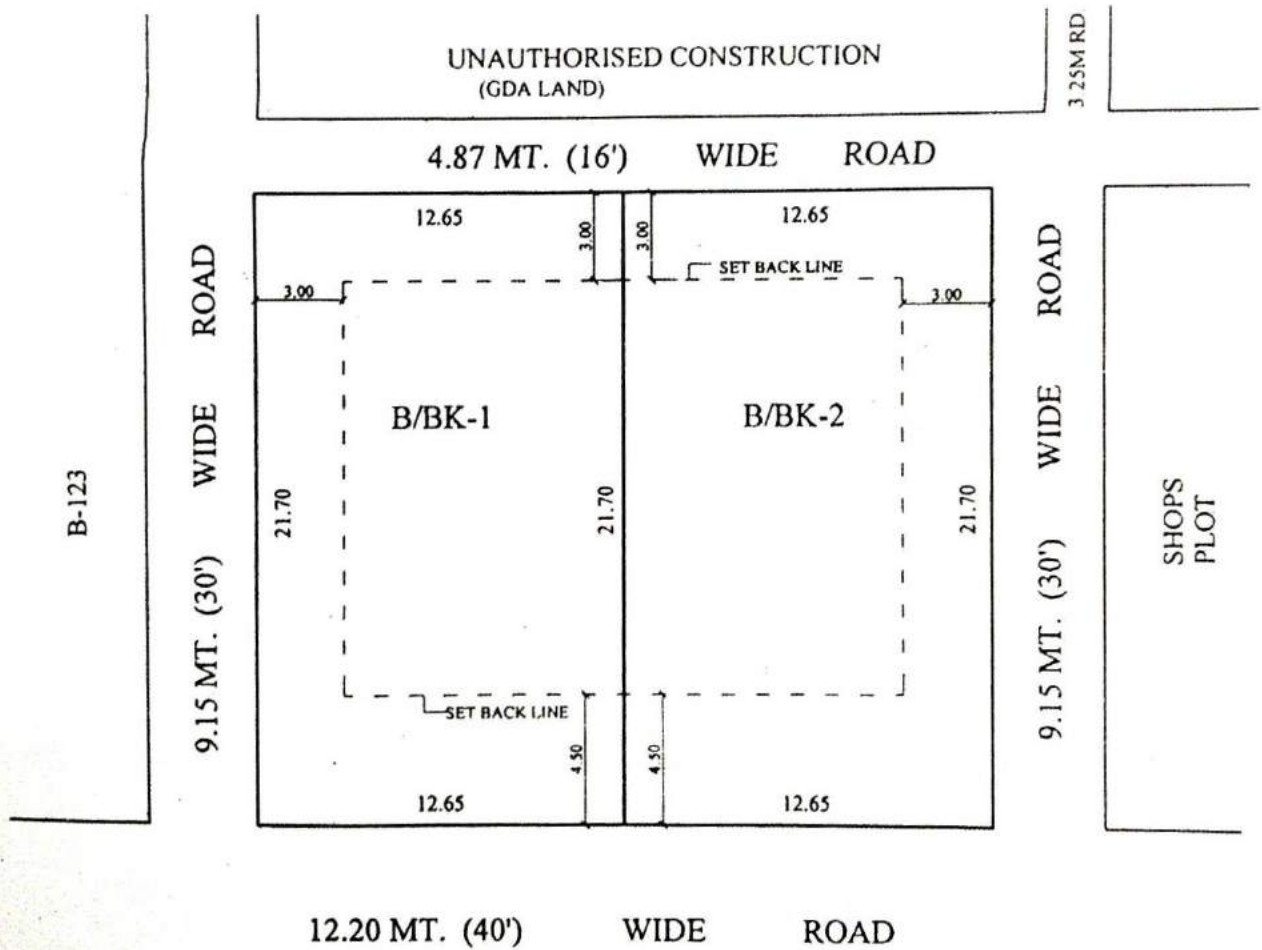

04/09/13
MAN
J.E. SA...
A.E.

E/19762

A.E.

E.E.

T.P.

C.A.T.P.

SECY.

प्लान - 410/मिमी: 31/5/2021

दिनांक 20/11/2021

WISED PART LAYOUT PLAN OF G.H.-1 AT PRATAP VIHAR SECTOR XI, G. M. P. GHAZIABAD.

AREA OF PLOT NO. G.H.-1 = 2871.80 SQ.M.
AREA OF PLOT NO. G.H.-1/1 = 6217.80 SQ.M.
AREA OF COMMERCIAL PLOT NO.-2 = 639.40 SQ.M.

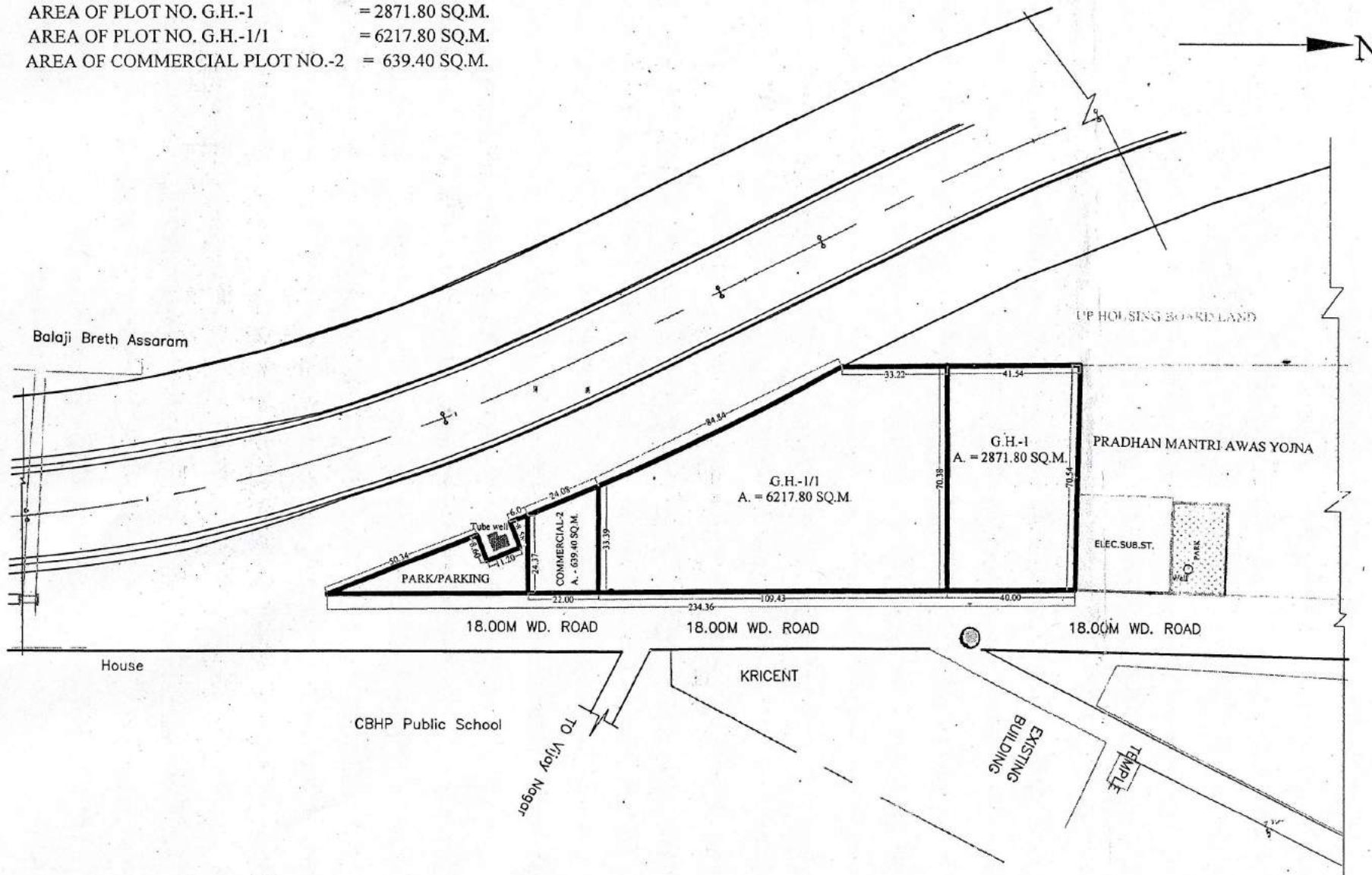

Handwritten signatures and initials are present at the bottom of the page, including 'Pm', '12/11/21', 'Ab', 'M', 'D', and 'TR'.

SITE PLAN FOR KIOSK IN "D" BLOCK PATEL NAGAR, SECTOR - 7 G.M.P. GHAZIABAD

Scale - 1:500

AREA OF KIOSK LAND = 116.84 Sqm.



[Handwritten Signature]
22.4.08

Prepared By.

[Handwritten Signature]
22.4.08

Compared By.

[Handwritten Signature]
22.4.08

Measured By.

[Handwritten Signature]
22.4.08

Astt. Engineer

[Handwritten Signature]
23/4/08

A.T.P.

[Handwritten Signature]
Town Planner.

REV. PART LAYOUT PLAN OF COMMERCIAL PLOTS (VEHICLE FREE) AT NYAY KHAND-1 INDIRAPURAM GZB.

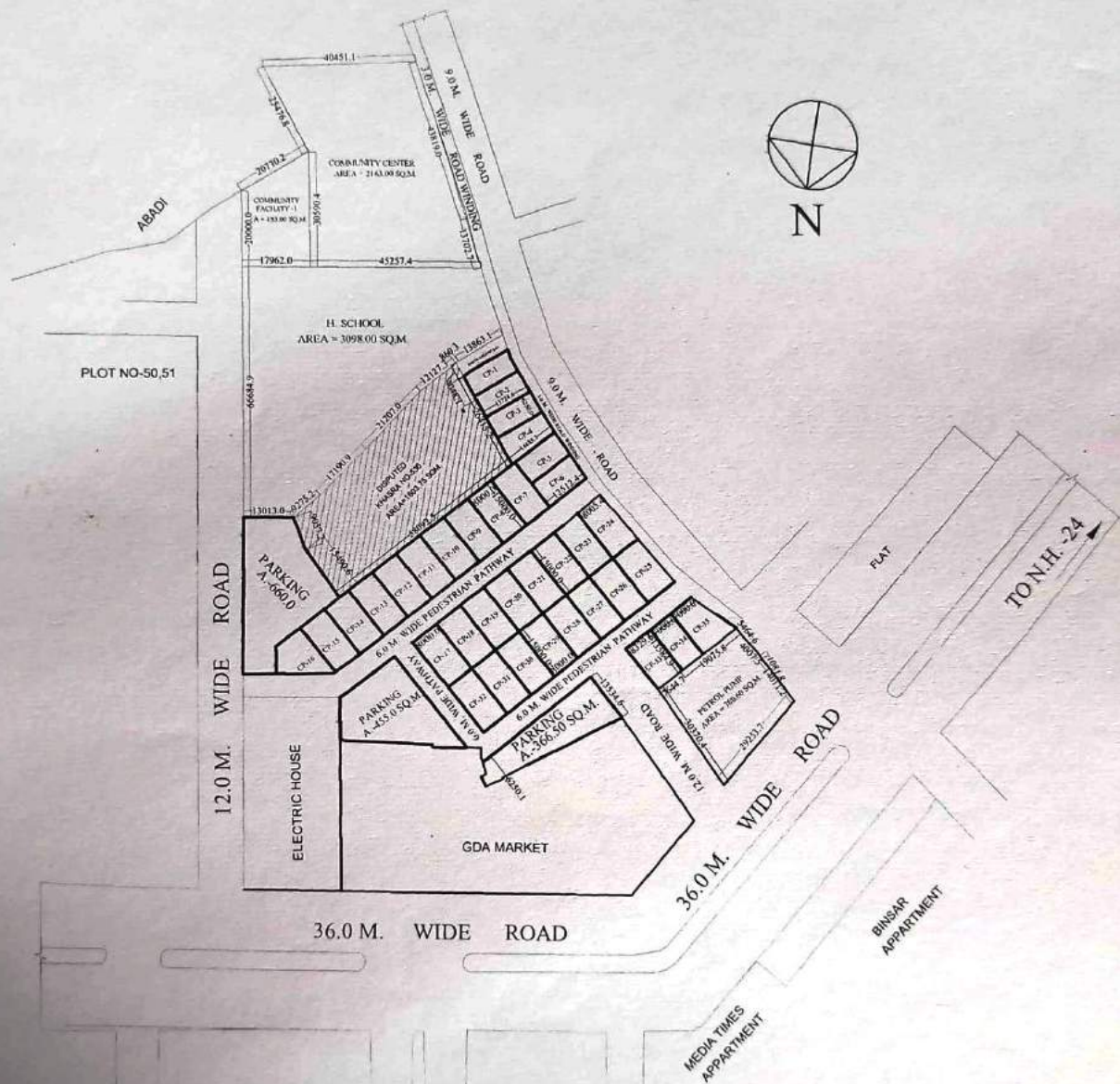

AREA-CHART

CP-1	= 87.02 Sqmt.
CP-2	= 88.07 Sqmt.
CP-3	= 88.71 Sqmt.
CP-4	= 101.05 Sqmt.
CP-5	= 94.87 Sqmt.
CP-6	= 99.13 Sqmt.
CP-7 to CP-15	= 120.00 Sqmt.
CP-16	= 116.24 Sqmt.
CP-17 to CP-32	= 120.00 Sqmt.
CP-33	= 113.10 Sqmt.
CP-34	= 95.06 Sqmt.
CP-35	= 125.30 Sqmt.
PARKING	= 1481.50 Sqmt
PETROL PUMP	= 760.60 Sq.mt.

REVISED SITE PLAN OF CONVENIENT SHOP PLOTS SK-IV/C.S.-1 TO C.S.-5 & VENDING ZONE AT SHAKTI KHAND - IV INDIRAPURAM GHAZIABAD.

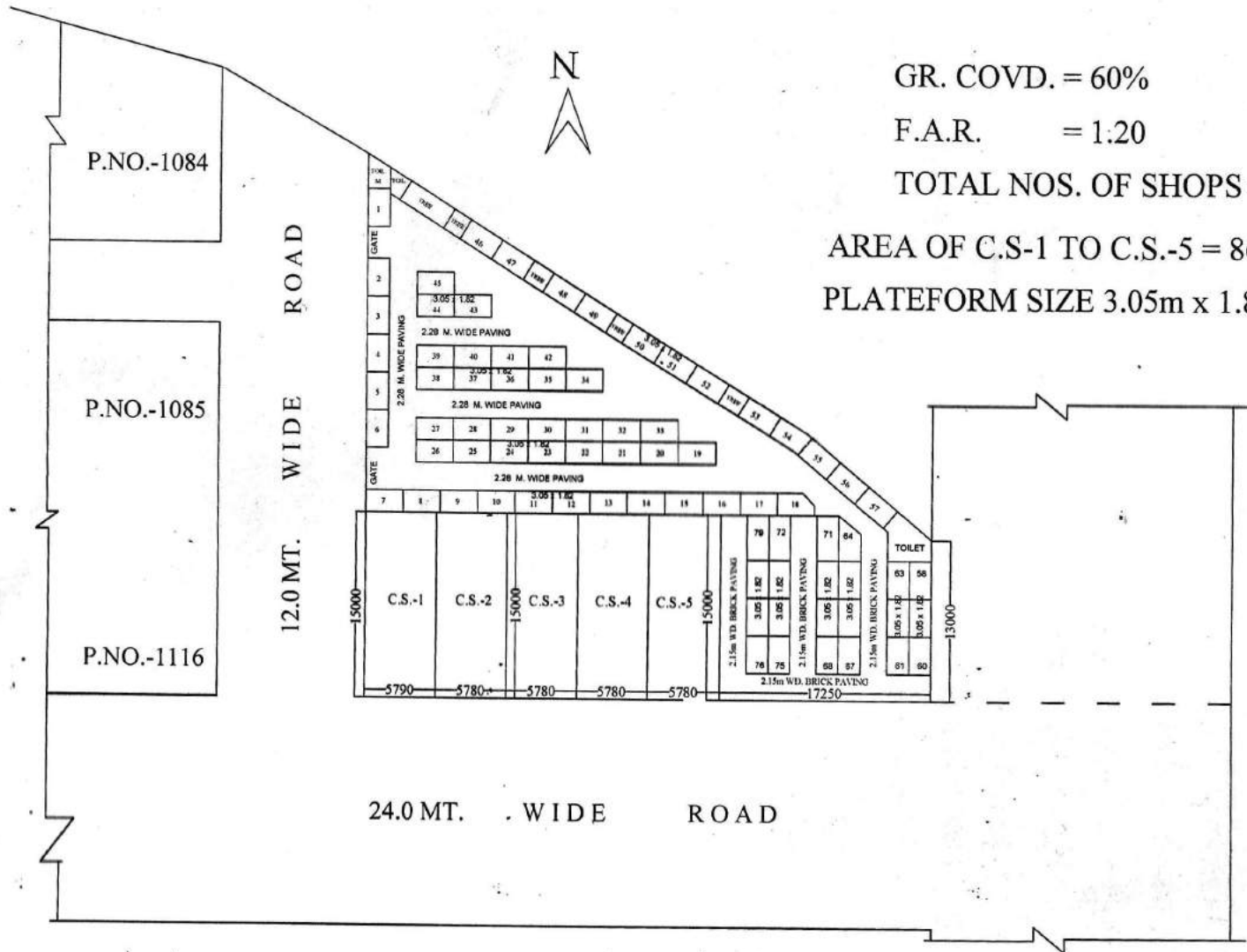

GR. COVD. = 60%

F.A.R. = 1:20

TOTAL NOS. OF SHOPS = 05

AREA OF C.S.-1 TO C.S.-5 = 86.70 SQ.M.

PLATFORM SIZE 3.05m x 1.82m

P.NO.-1084

P.NO.-1085

P.NO.-1116

12.0 MT. WIDE ROAD

24.0 MT. WIDE ROAD



D.MAN

J.E.

A.E.

A.T.P.

E.E.

T.P.

C.A.T.P.

SECRY

V.C.

REVISED SITE PLAN OF PLOT NO. SK-94 IN SHASTRI NAGAR SECTOR-XVI GZB.

AREA OF PLOT SK-94 = 358.65 SQ.M.

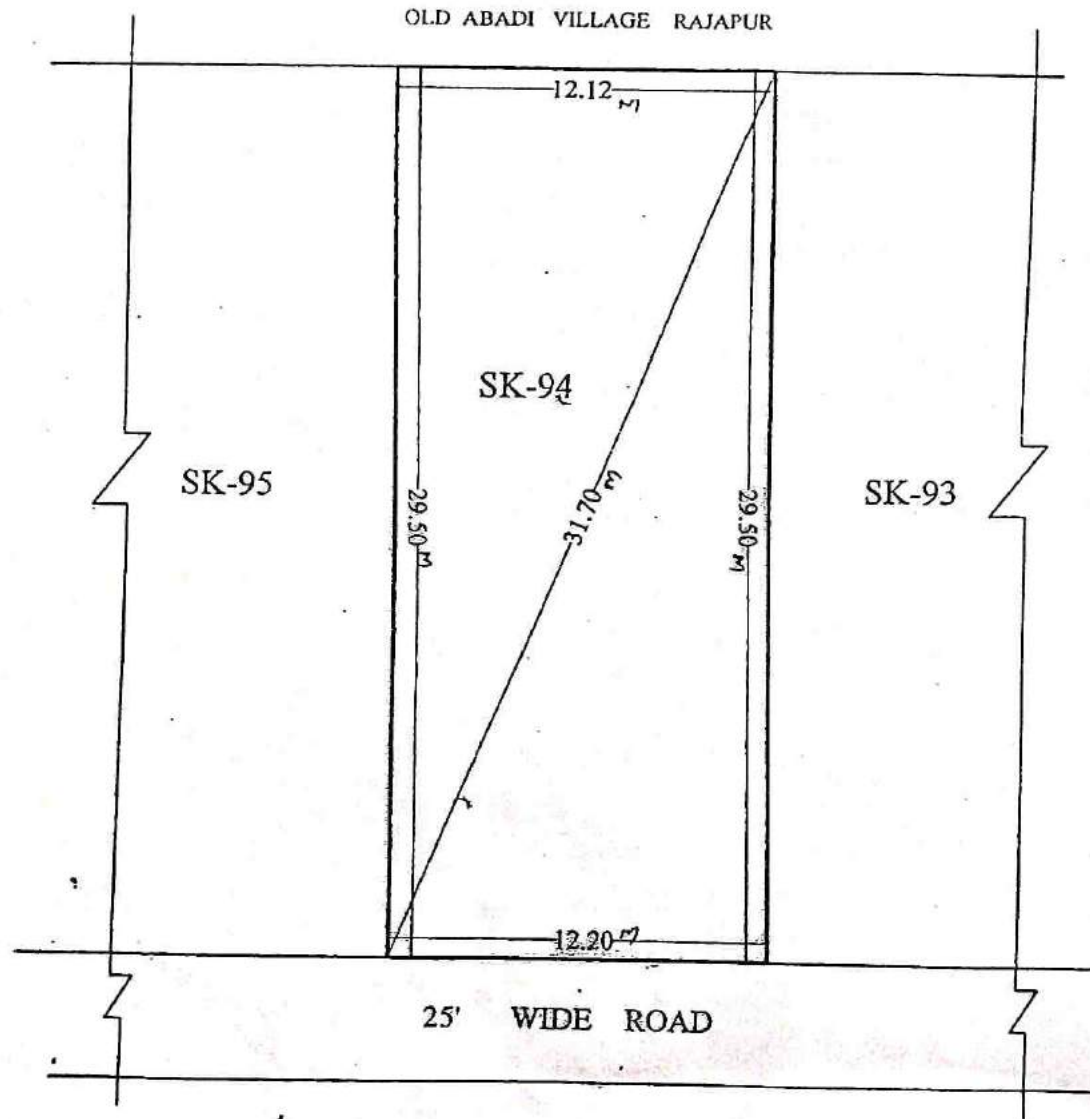
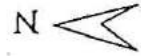



16/02/18
PREPARED BY.

22-02-18
COMPARED BY.

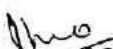
J.E.(MEAS.& AREA CAL BY)

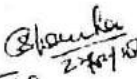

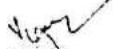
12-2-18
ASST. ENGR.

2-2-18
E.E.

A.T.P.

TOWN PLANNER

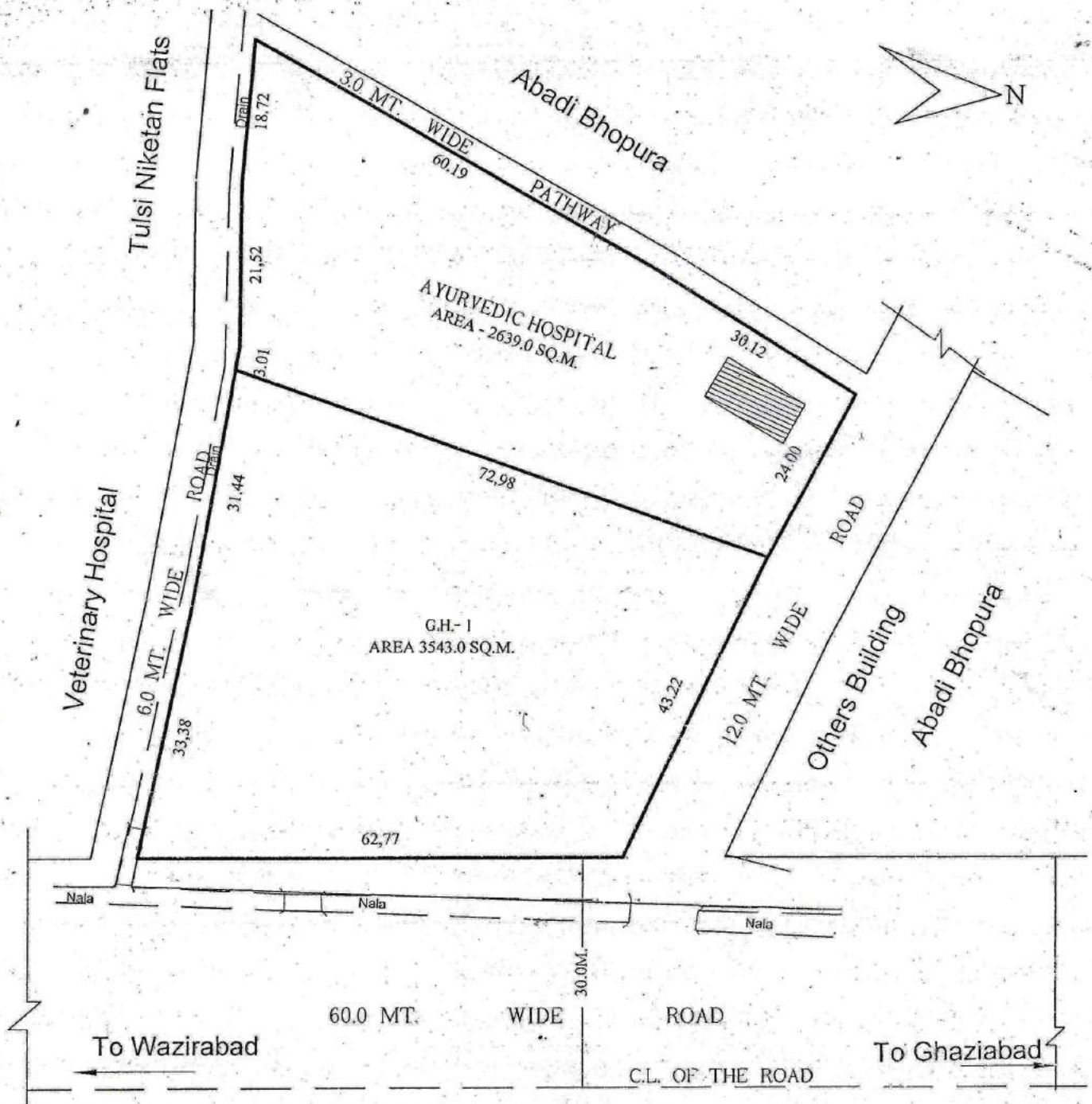
PART LAYOUT PLAN OF TULSI NIKETAN RESIDENTIAL SCHEME THA
 GHAZIABAD.



[Signature]
 30/5/15
 D.M.A.N.

[Signature]
 30/5/15
 A.M.I.N.

[Signature]
 J.E.

[Signature]
 30/5/15
 A.E.

[Signature]
 30/5/15
 E.E.

[Signature]
 30/5/15
 T.E.H.-L.A.

[Signature]
 30/5/15
 T.P.

[Signature]
 30/5/15
 C.A.N.T.P.

[Signature]
 30/5/15
 S.E.C.Y.

[Signature]
 V.C.

AT TULSI NIKETAN SCHEME THA IN GHAZIABAD

SCALE : 1 CM = 5 Mts.

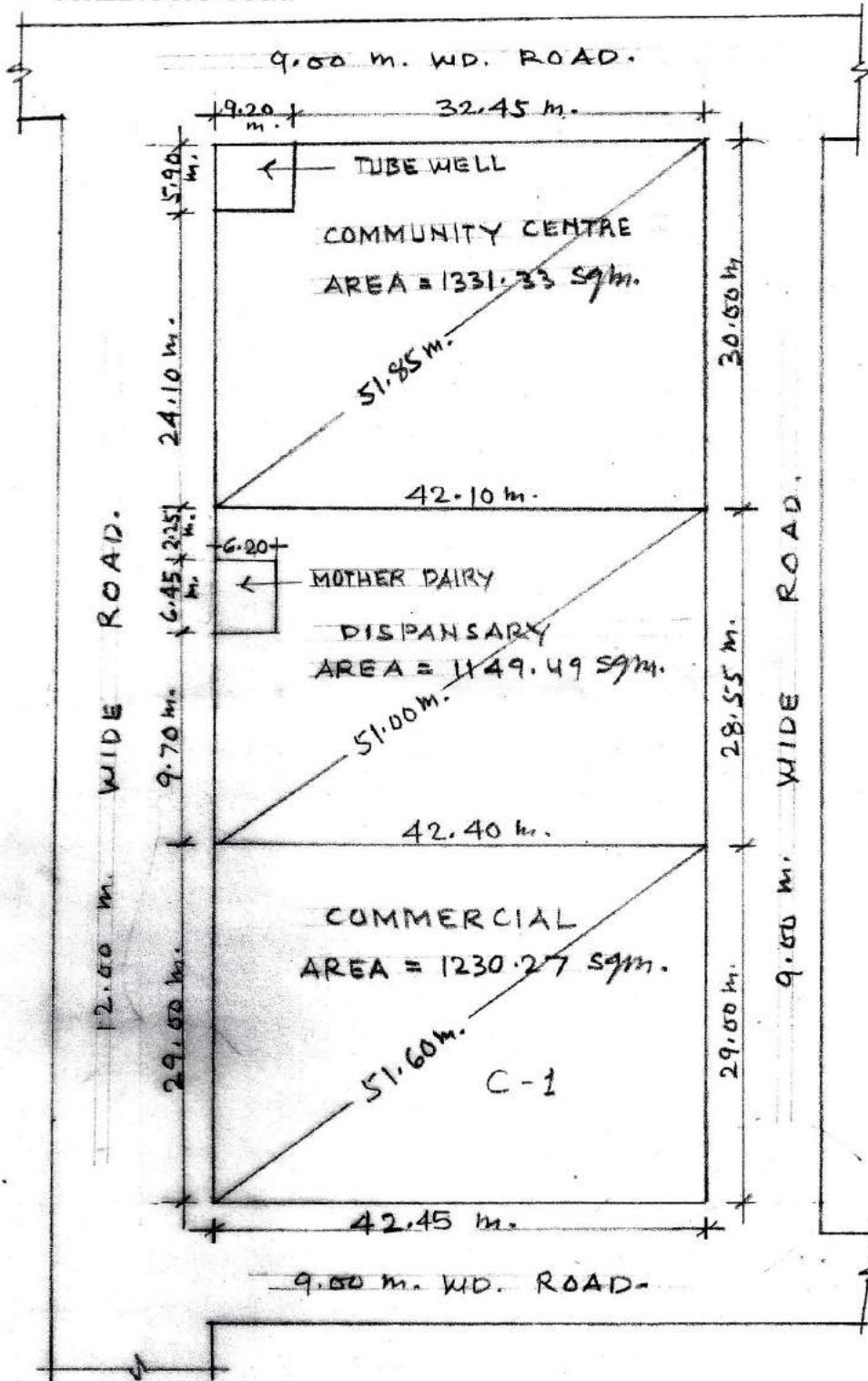

Ahmed / 10/01/07
Salim / 11/01/07
Ammy / 22/01/07
Flow / 22/01/07
X/good / 21/01/07
 PREPARED BY COMPARED BY MEASURED BY ASST ENGR. TOWN PLANNER

**SITE PLAN OF SHOP NO. - , POCKET - B, AT SCHEME NO. - 10, DELHI UP BORDER
SCHEME ON KHASRA NO. - 3,4 & 10 VILLAGE CHIKAMBAR PUR, G.T. ROAD GHZIABAD.**



SHOPS PLOT AREA DETAIL	
SHOPS PLOT No.	AREA (Sq.m.)
94	55.36
95	44.77
96	44.77
97	56.37

Prepared By
25/09/19

Compared By
26/09/19

J. Engr.(MEAS. & AREA CAL. BY)
30/9/19

Astt. Engg.

T.P.(R)

T.P.(R)

THE PLAN OF SHOP No. - , POCKET - A, AT SCHEME No. - 10, DELHI UP BORDER
 SCHEME ON KHASRA No. - 3,4 & 10 VILLAGE CHIKAMBAR PUR, G.T. ROAD GHZIABAD.

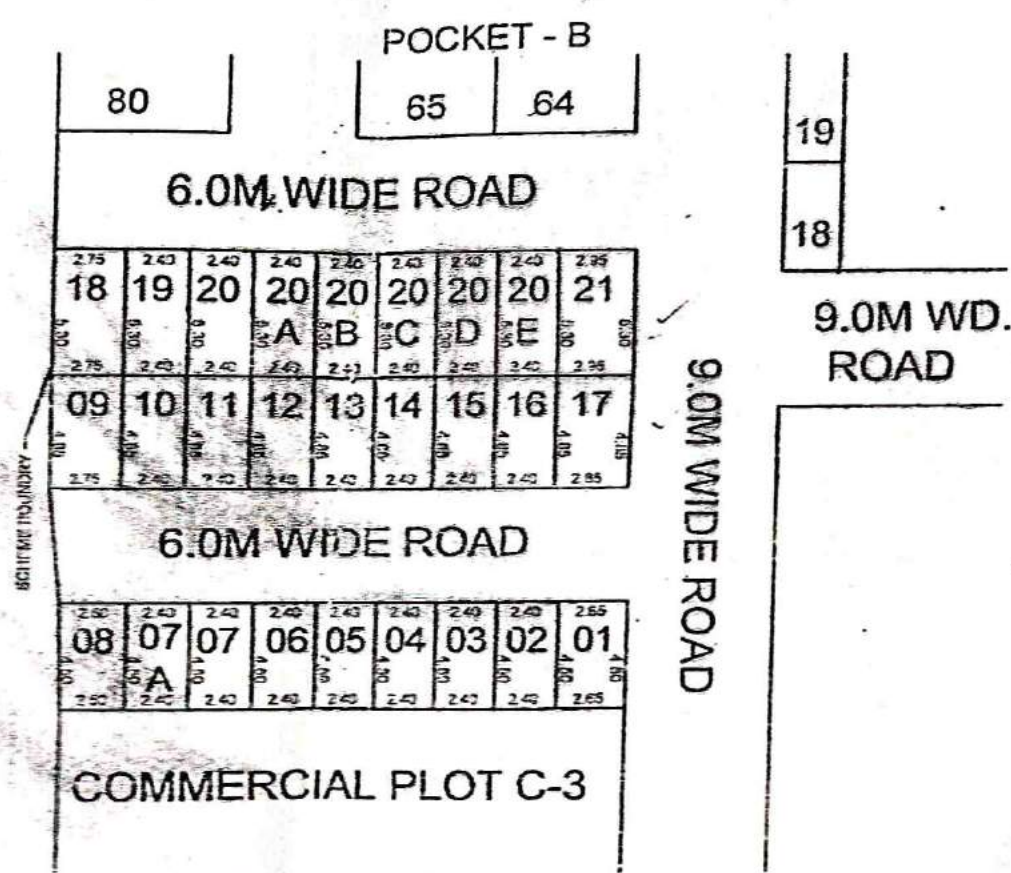

SHOPS PLOT AREA DETAIL	
SHOPS PLOT No.	AREA (Sq.m.)
01	11.925
02 TO 7A	10.80
08	11.475
09	13.337
10 TO 16	11.64
17	14.065
18	14.575
19 TO 20E	12.72
21	15.635

[Signature]
 17/04/19
 Prepared By

[Signature]
 20/04/19
 Compared By

[Signature]
 J.Engr.(Meas. & Area Cal. By)

[Signature]
 Astd. Engg.

[Signature]
 T.P.

TE PLAN OF SHOP NO. - POCKET - B, AT SCHEME NO. - 10, DELHI UP BORDER
 SCHEME ON KHASRA NO. - 3,4 & 10 VILLAGE CHIKAMBAR PUR, G.T. ROAD GHZIABAD.

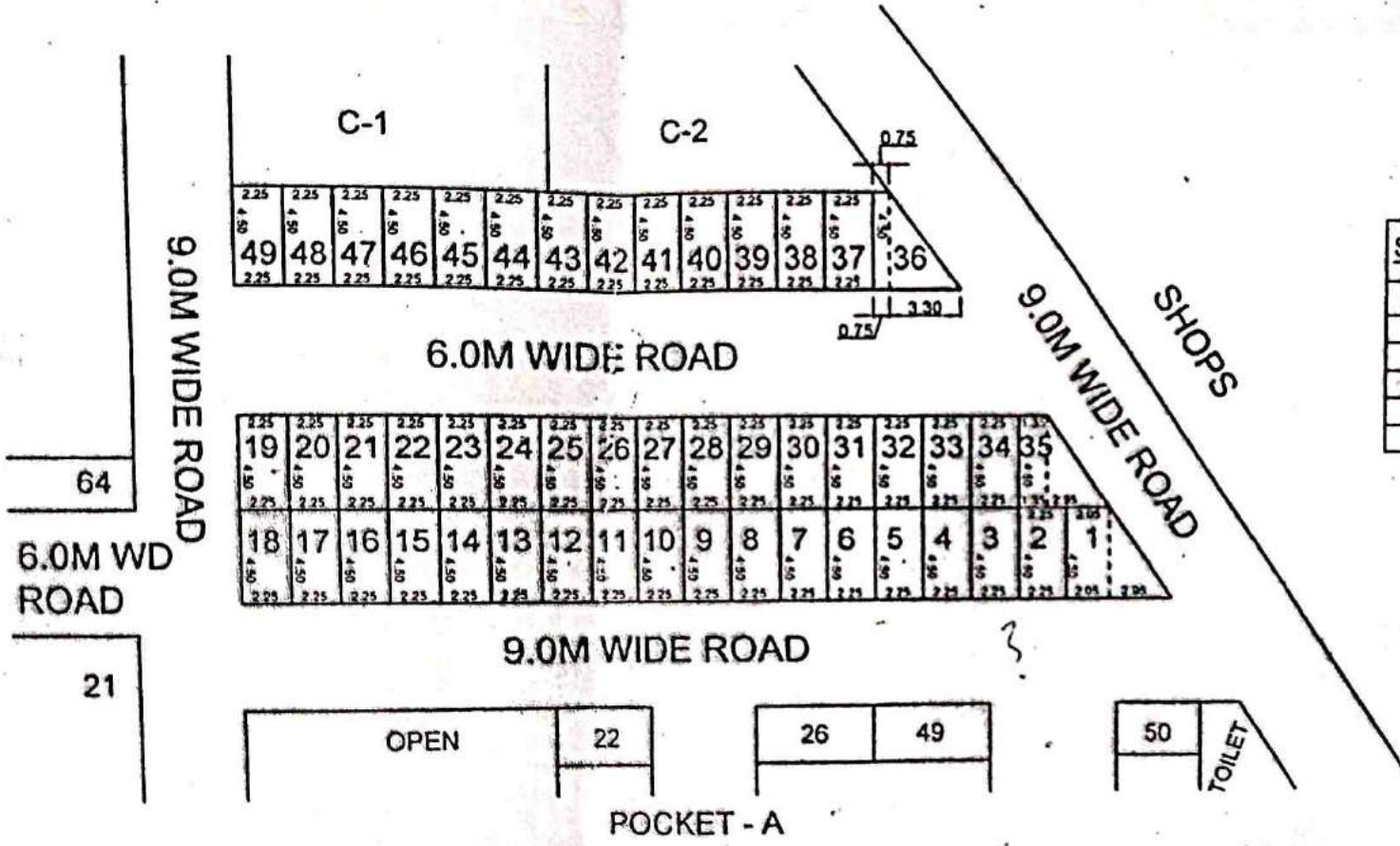

SHOPS PLOT AREA DETAIL	
SHOPS PLOT No.	AREA (Sq.m.)
1	15.862
2 TO 34	10.125
35	12.712
36	10.80
37 TO 49	10.125

[Signature]
 17/01/19
 Prepared By

[Signature]
 20/04/19
 Compared By

[Signature]
 J. Engr. (MEAS. & AREA CAL. BY)

[Signature]
 Astit. Enng.

[Signature]
 T.P.

प्लान अर्धी से क्रमांक - 200 से 294

SITE PLAN OF SHOP NO. - , POCKET - A, AT SCHEME NO. - 10, DELHI UP BORDER SCHEME ON KHASRA NO. - 3,4 & 10 VILLAGE CHIKAMBAR PUR, G.T. ROAD GHZIABAD.

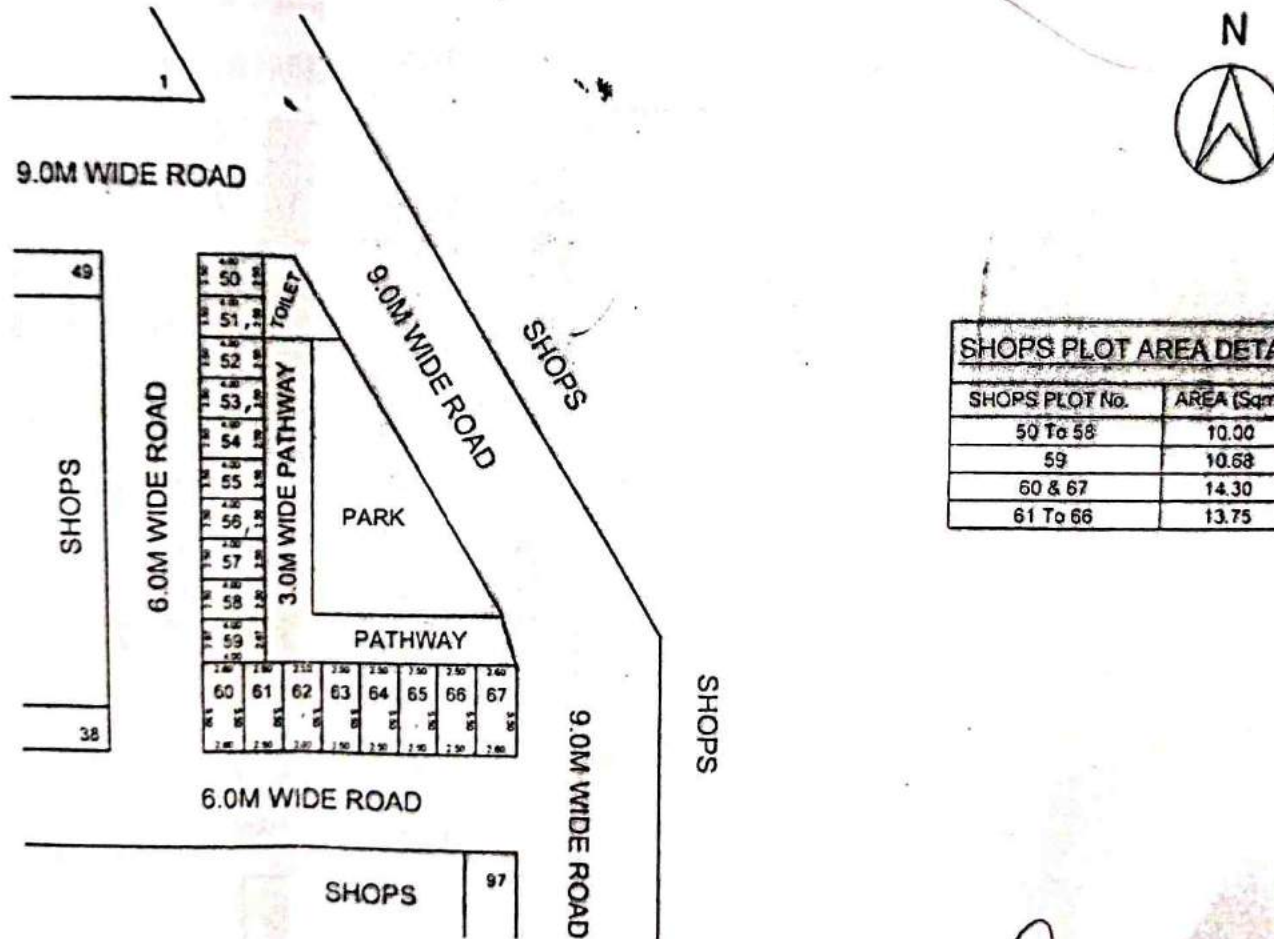

SHOPS PLOT AREA DETAIL	
SHOPS PLOT No.	AREA (Sq.m.)
50 To 58	10.00
59	10.68
60 & 67	14.30
61 To 66	13.75

Prepared By
02/06/19

Compared By
02-07-19

J.ENGR.(MEAS. & AREA CAL. BY)

Astt. Engg.

प्लान मुचा जे कडाक

~~3033304~~ 3033304

SITE PLAN OF SHOP NO. - , POCKET - A, AT SCHEME NO. - 10, DELHI UP BORDER SCHEME ON KHASRA NO. - 3,4 & 10 VILLAGE CHIKAMBAR PUR, G.T. ROAD GHZIABAD

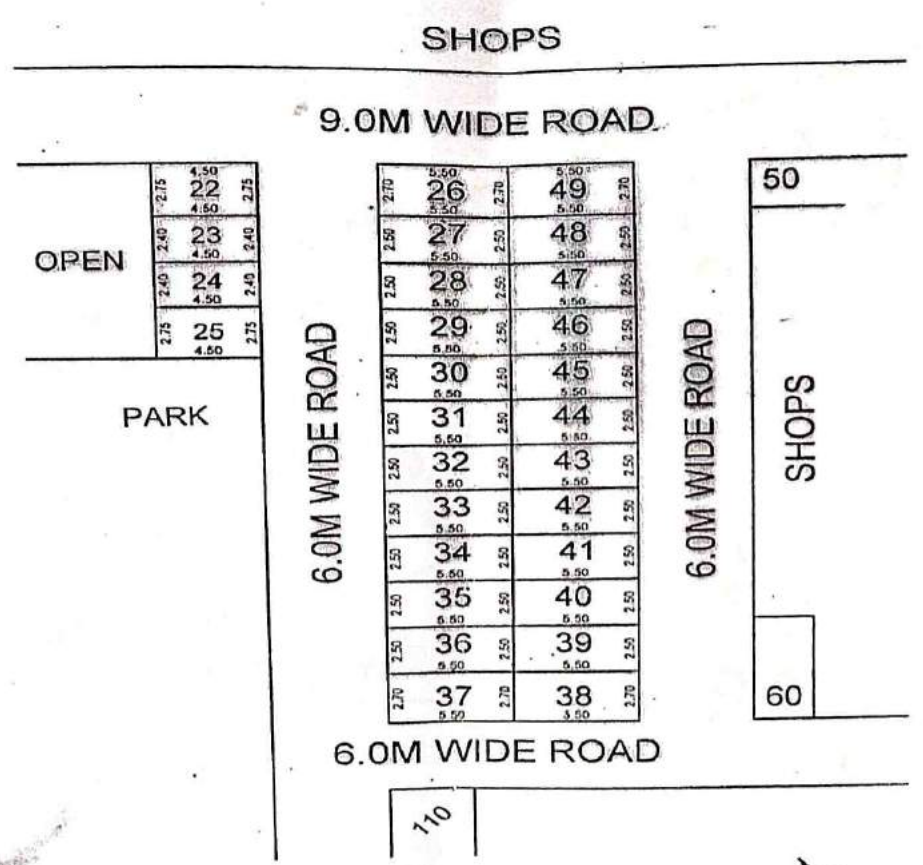

SHOPS PLOT AREA DETAIL	
SHOPS PLOT No.	AREA (Sq.m.)
22 & 25	12.375
23 & 24	10.80
26 & 37, 38 & 49	14.85
27 TO 36, 39 TO 48	13.75

[Signature]
17/01/19
Prepared By

[Signature]
20/04/19
Compared By

[Signature]
J. Engr.(MEAS. & AREA CAL. BY)

[Signature]
Astt. Engg.

[Signature]
T.P.

**SITE PLAN OF SHOP PLOT No. - , POCKET - A, SCHEME No. - 10, DELHI UP BORDER ON
KHASRA No. - 3,4 & 10 AT CHIKAMBAR PUR ON G.T. ROAD GHZABAD.**

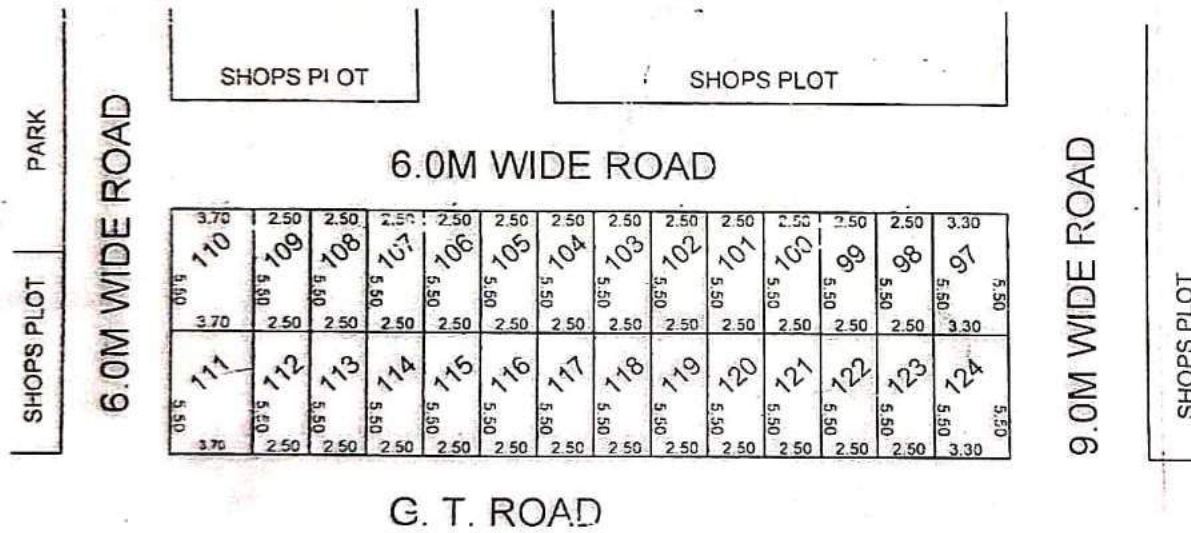
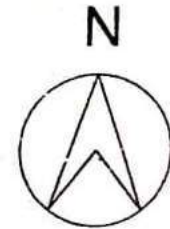

SHOPS PLOT No.	AREA (Sq.m.)
97	18.15
98 TO 109	13.75
110	20.35
111	20.35
112 TO 123	13.75
124	18.15

[Signature]
Prepared By
15/5/17

[Signature]
Compared By
16/5/17

[Signature]
Measured & Area Cal. By

[Signature]
Asth. Engh.

[Signature]
T.P.
15/5/17

PROPOSED PART LAYOUT PLAN AT SECTOR III, BEHIND CHAAYA PUBLIC SCHOOL.VAISHALI
 (POCKET - NP)

PLOTS SIZE = 16.50 X 8.50 M.
 AREA = 140.25 SQ M.
 NO. OF PLOTS = 18

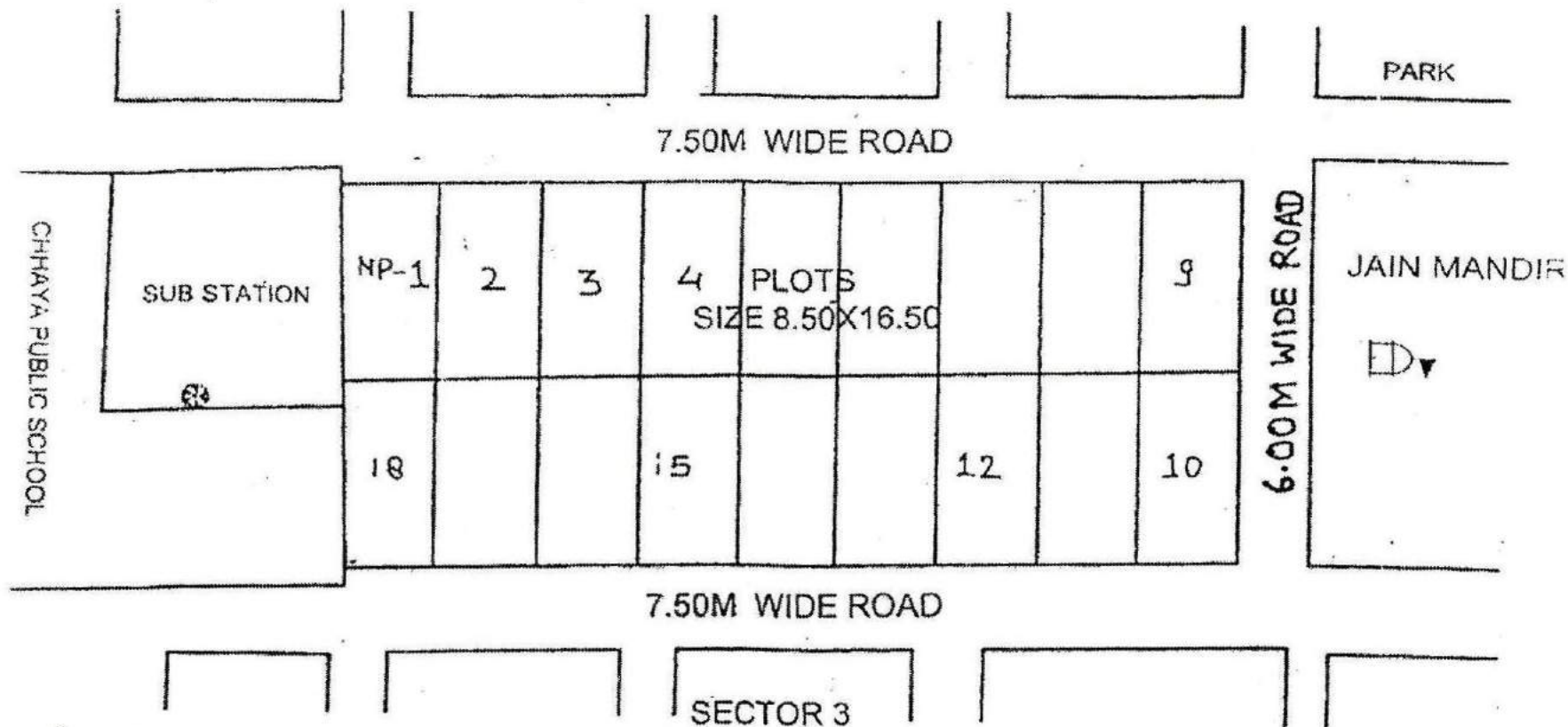
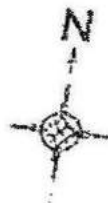

[Signature]
 D/MAN

[Signature]
 19/11/2012
 TOWN PLANNER

[Signature]
 CATP

[Signature]
 SECY.

[Signature]

REVISED SITE PLAN FOR COMMUNITY CENTER & NURSING HOME AT SECTER-3 VAISHALI, GHAZIABAD

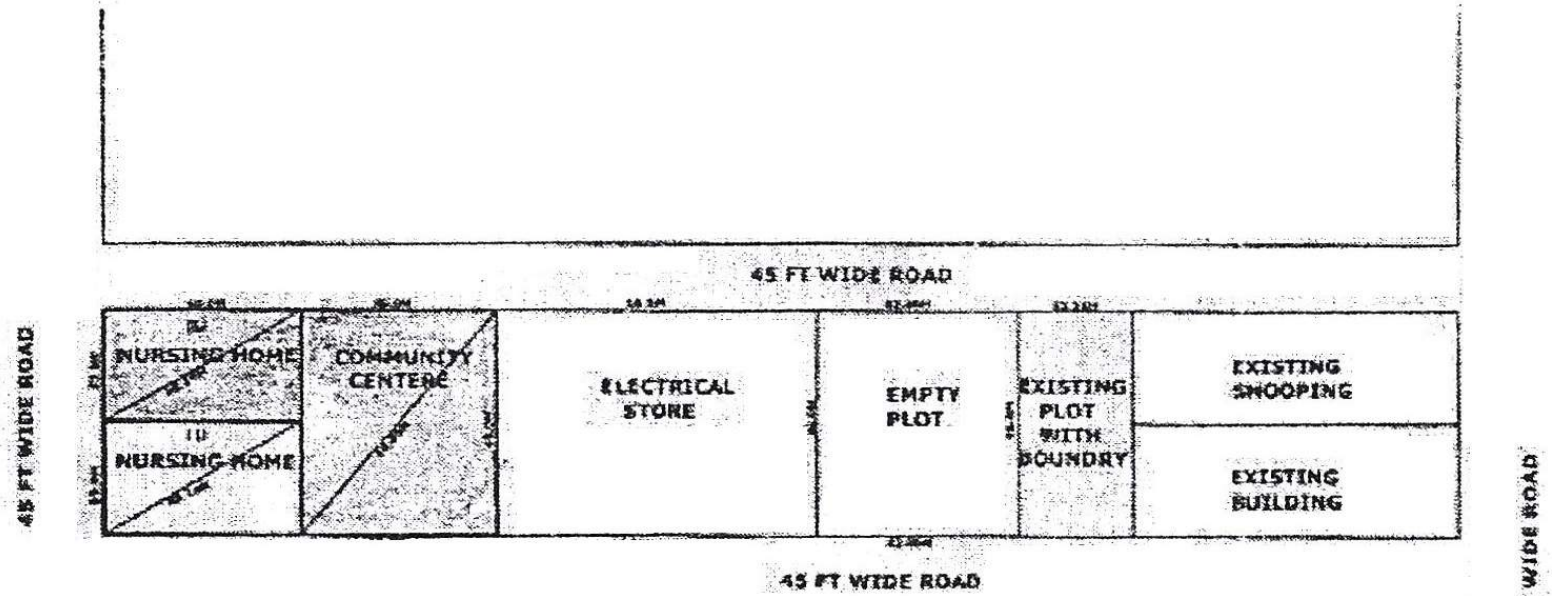

NURSING HOME NO- 1	AREA	40.0M X 23.0M	=	920 S.Q.M
NURSING HOME NO- 2	AREA	40.0M X 23.0M	=	920 S.Q.M
COMMUNITY CENTER	AREA	40.00M X 46.0M	=	1840 S.Q.M



[Signature]
D/M

[Signature]
AMIN

[Signature]
J.E

[Signature]
A.E

E.E-5

[Signature]
TEH (LA)

[Signature]
T.D

[Signature]
C.A.P

[Signature]
SECRETARY

[Signature]

**SITE PLAN OF HIGH SCHOOL PLOT CONVERT IN TO G.H / RESI.PLOT/POST OFFICE AT SECTER -3
VAISHALI GHAZIABAD**

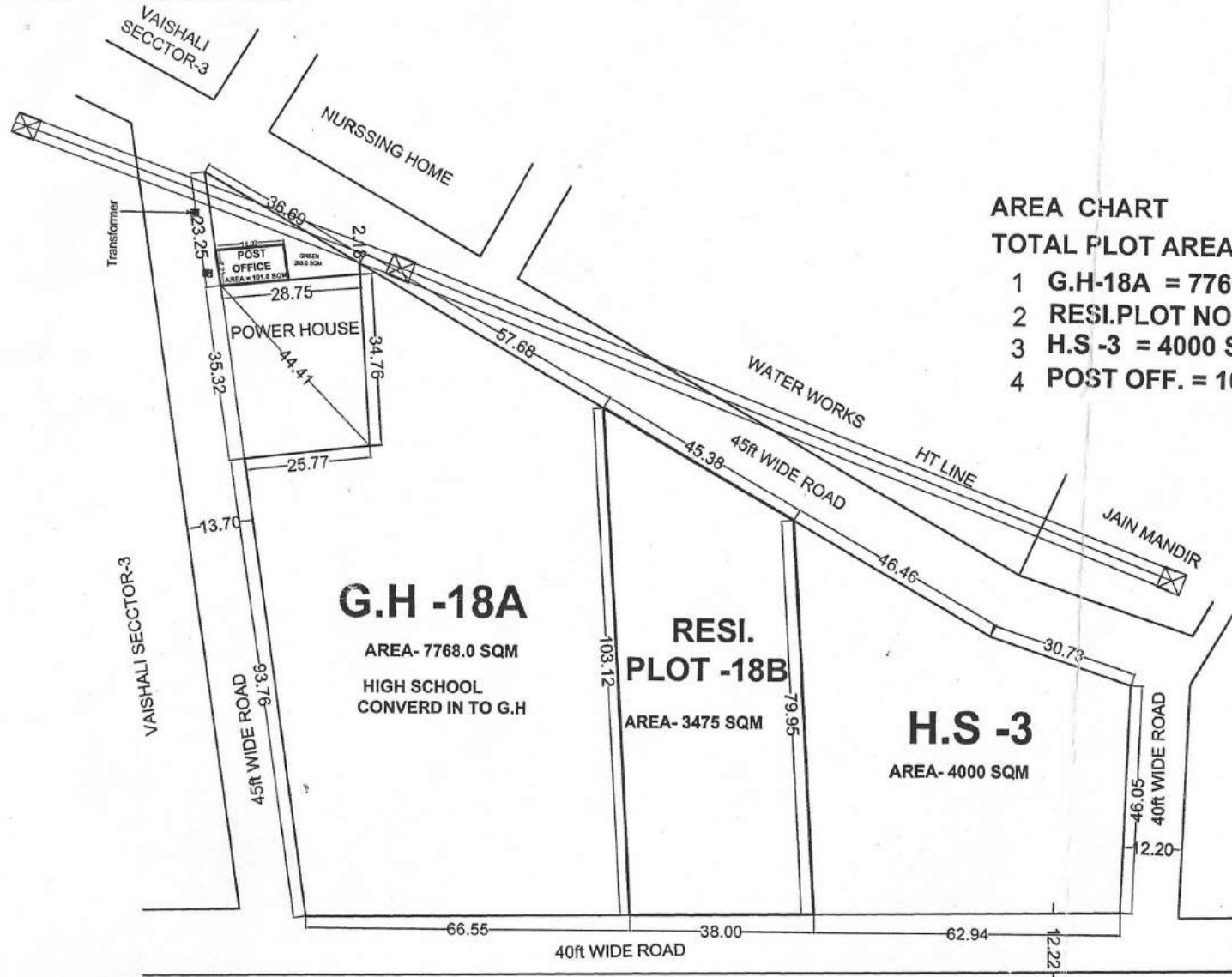

AREA CHART

TOTAL PLOT AREA-15241 SQM

- 1 G.H-18A = 7768.0 SQM
- 2 RESI.PLOT NO-18B = 3475 SQM
- 3 H.S -3 = 4000 SQM
- 4 POST OFF. = 101.0 SQM

G.H -18A

AREA- 7768.0 SQM
HIGH SCHOOL
CONVERD IN TO G.H

**RESI.
PLOT -18B**

AREA- 3475 SQM

H.S -3

AREA- 4000 SQM

[Signature]
21/10/16
D/M.

[Signature]
T.P.

[Signature]
C.A.T.P

[Signature]
21/10/16
SECY.

[Signature]
V.C

REVISED SITE PLAN FOR COMMUNITY CENTER & NURSING HOME AT SECTER-3 VAISHALI, GHAZIABAD

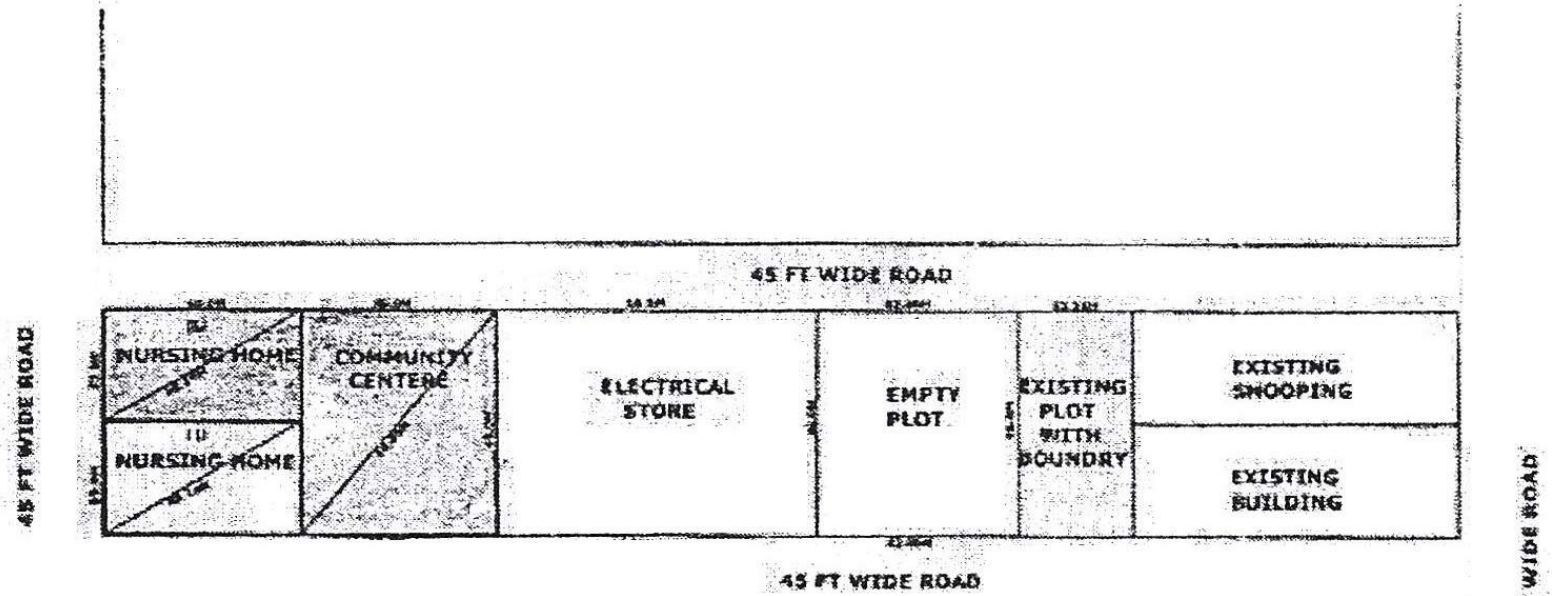

NURSING HOME NO- 1	AREA	40.0M X 23.0M	=	920 S.Q.M
NURSING HOME NO- 2	AREA	40.0M X 23.0M	=	920 S.Q.M
COMMUNITY CENTER	AREA	40.00M X 46.0M	=	1840 S.Q.M



[Signature]
D/M

[Signature]
AMIN

[Signature]
J.E

[Signature]
A.E

E.E-5

[Signature]
TEH. (LA)

[Signature]
T.D

[Signature]
C.A.T.P

[Signature]
SECRETARY

[Signature]

PROPOSED PART LAYOUT PLAN AT SECTOR VI VAISHALI :

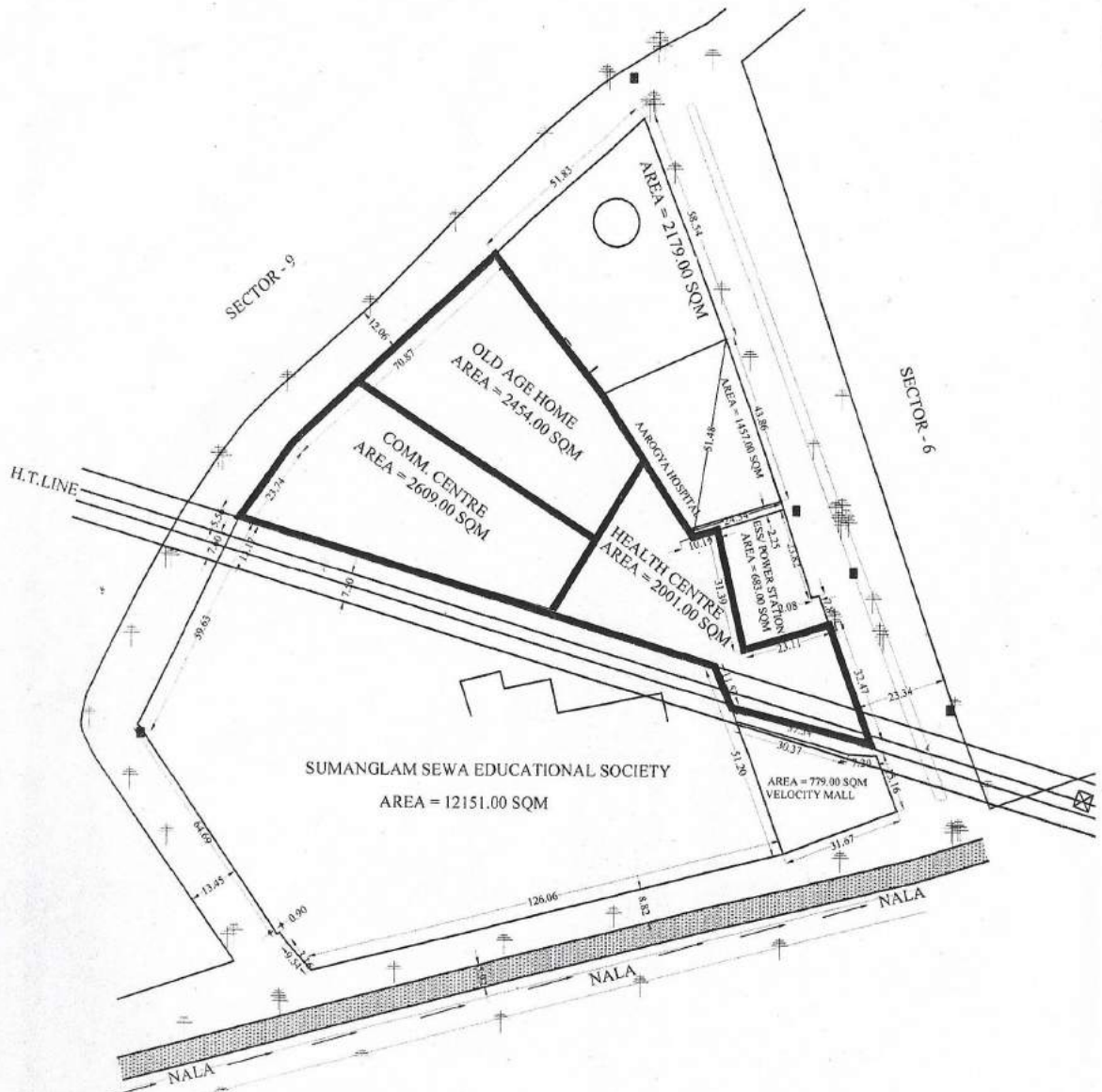

 D/MAN
 J.E.
 A.E.
 E.E.
 T.P.
 C.A.T.P.